

## Tips For Using The Deluxe Photo Etch Brass Assist



Manufactured in the USA by  
Kalama Precision Machine  
The Small Shop  
PO Box 580  
Kalama WA 98625  
Phone/Fax: 360.673.1255  
Email info@thesmallshop.com

### The *Brass Assist* Roller Set Mk 'MC'

The Brass Assist ROLLER-SET Mk 'MC' has many new features when compared to earlier models, these have been added after much feedback from our customers who have the 'early' types of wooden/plastic roller sets....we thank all those who passed on their thoughts and ideas.

#### All Metal construction

A 'Super-Hard' clear anodizing gives a 'slippery' surface and prevents damage to the base unit. Visual contrast between the Brass Assist base and your brass parts is, as with our range of Hold & Fold tools, maintained by this color. The contrast assists in making very small parts.

#### All Metal Forming-Rollers

Wooden dowels have been replaced, all metal rollers are easy to use, remain undamaged and stay clean even when using talc for lubrication.

#### Soft Rolling Deck

Allows 'true' cylinders to be 'rolled'. This bed is easy to replace if it becomes worn or damaged.

#### Pre Etched Tie Down Beams

Place etch part over beam, push down with tweezers.  
Form your 'Pre-Etched' tie downs with ease and accuracy. Many parts from hinges, tool clamps, and brackets can be formed with ease.

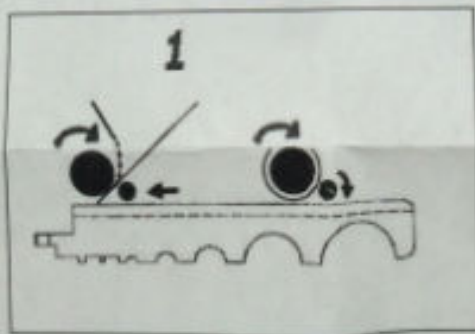

## Tips For Using The Deluxe Photo Etch Brass Assist

### Using the Rubber Rolling Deck

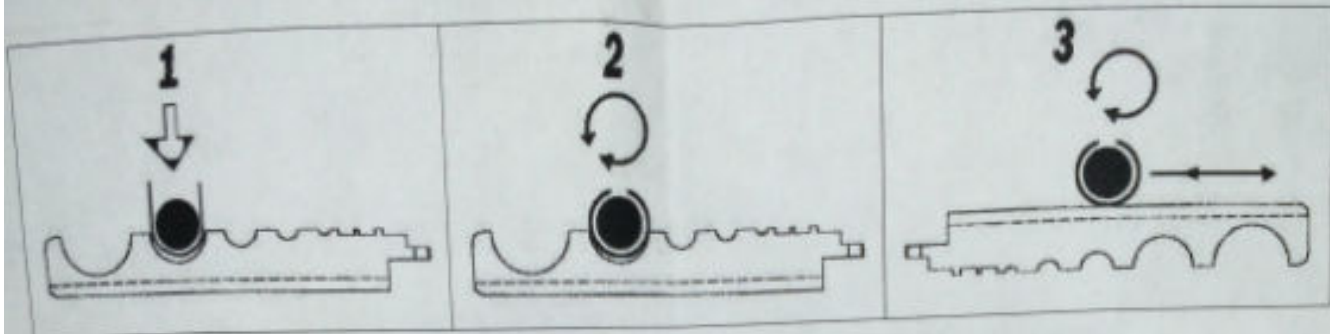

### Details and HOW-TO-DO

#### The Soft Rolling Deck

On the **UNDERSIDE** of the unit is a soft rubber rolling surface, to enable 'true' cylinders to be rolled. On the **TOP** deck, pre form the cylinder around an oversized rod and cut out. Heating the brass to remove its 'spring' can help with cylinders. Using a smaller sized rod, flip over the Roller-Set Mk C and position on the rubber mat. Roll back and forth until the cylinder is formed.

#### Pre Etch Tie Down Beams Bending Beams

Across the whole width of the top deck run two pre sized 'Bending-Beams', these are used for bending the pre-formed and pre-etched tie-downs sold by makers such as Aber and Edward, no longer a pain to work with when you use these features.

1. Cut off your pre-etched part or chop wire to the required lengths.
2. Pre position your part with tweezers.
3. Hold part in position with a blade tip and align to center of the beam.
4. Use tweezers and bend the sides down.
5. Pick up part and turn the feet over or use your Hold & Fold to do this for more accuracy and prevention of the loss to the 'Carpet-Monster'

#### Grab Handles with the Bending Comb

Create match sized grab handles every time, designed for use with soft copper or brass wire. **DO NOT USE HARD WIRE** - For best results semi-hard wire should first be annealed. Heat to dull red and allow to air cool. The technique is easy to master. Grab handles of many different sizes can be made. Three sizes of leg from 1mm to 3mm combined with 1mm to 6mm in length in each leg size.

1. Loop the wire over your chosen comb set.
2. Press down firmly on top of the loop to square the angles.
3. Tug down on each leg to sharpen the top turn (take care not to damage the bending fingers).
4. Tug outwards on each length to form the leg.
5. Remove the now formed wire handle and further sharpen the angles if required by using a pair of pliers.
6. Cut off excess wire.
7. Squash ends to form the welded ends.
8. Handle is ready to be attached!