

PLEASE !! READ THROUGH ALL OF THE INSTRUCTION STEPS BEFORE STARTING. THE PARTS ARE DESIGNED TO BE PRECISE FITTING AND SOME ASSEMBLIES BUILD ON PREVIOUS STEPS.

ALL PARTS MAY BE PAINTED BEFORE ASSEMBLY WHILE THEY ARE STILL ON THEIR SPRUES. ONCE THE WALL PARTS HAVE BEEN PAINTED, THEY CAN BE CUT FROM THE SPRUE. INSTALLING THE WINDOWS AND DOORS AND SOME OF THE TRIM MAY BE ADVANTAGEOUS AT THIS POINT. COMPLETED WALL SECTIONS CAN THEN BE ASSEMBLED PER THE INSTRUCTIONS.

1. BEFORE YOU BEGIN CONSTRUCTION, TAKE THE TIME TO BECOME FAMILIAR WITH THE PARTS AND INSTRUCTIONS. THE PARTS ARE NUMBERED TO MAKE IT EASIER TO FIND THEM ON THE SPRUES.
2. THE WINDOWS AND DOORS HAVE A DOUBLE STICK ADHESIVE BACKING TO ALLOW THEM TO BE APPLIED TO THE GLAZING. WE RECOMMEND THAT YOU PAINT THE WINDOWS AND DOORS WHILE THEY ARE STILL ATTACHED TO THE SPRUE. SPRAY PAINT WORKS BEST FOR THIS.
3. WE RECOMMEND VALLEJO BRAND ACRYLIC PAINTS FOR THIS KIT.

AS WITH ALL OF OUR KITS WE HOPE YOU ENJOY BUILDING AND FINISHING THIS MODEL. PLEASE LET US KNOW OF ANY SUGGESTIONS OR IDEAS YOU MIGHT HAVE TO IMPROVE OUR KITS.

PLEASE VISIT OUR WEBSITE AT WWW.SHOWCASEMINIATURES.NET TO ENSURE THAT YOU HAVE THE LATEST VERSION OF THE ASSEMBLY INSTRUCTIONS.

PARTS

A

B

C

D

E

F

G

H

I

J

K1

METAL DETAIL PARTS

HI-RES GRAPHICS

WATERSLIDE DECALS

GLAZING

THREAD FOR ROPE

REMOVE CENTER SECTIONS BEFORE ASSEMBLY TO ALLOW ACCESS TO THE INTERIOR BEFORE ADDING ROOF

WATERSLIDE DECALS ARE INCLUDED BUT ARE NOT RECOMMENDED. THEY MUST BE CUT CLOSE TO THE EDGE OF THE GRAPHIC. GLAZING IS APPLIED TO THE INSIDING FACE OF PLASTICS ON SURFACE OF

DRY-FIT ALL PARTS BEFORE APPLYING GLUE

STEP 1 ASSEMBLE THE WALLS

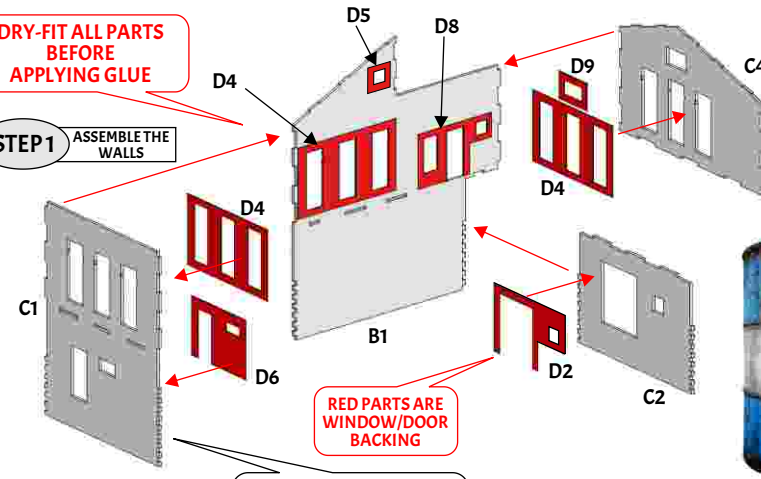

STEP 2 INSTALL THE SECOND FLOOR

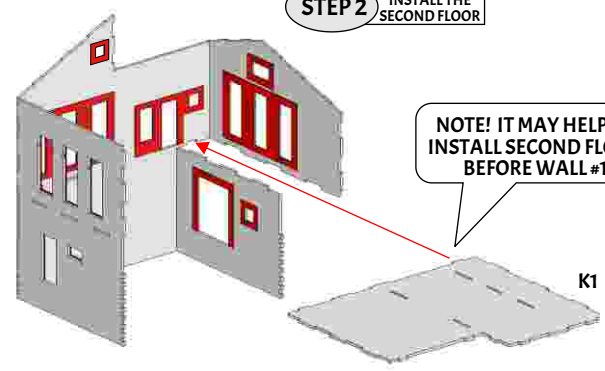

NOTE! IT MAY HELP TO INSTALL SECOND FLOOR BEFORE WALL #1

NOTE! IT MAY HELP TO INSTALL SECOND FLOOR BEFORE WALL #1

STEP 3 FINISH ASSEMBLING THE WALLS

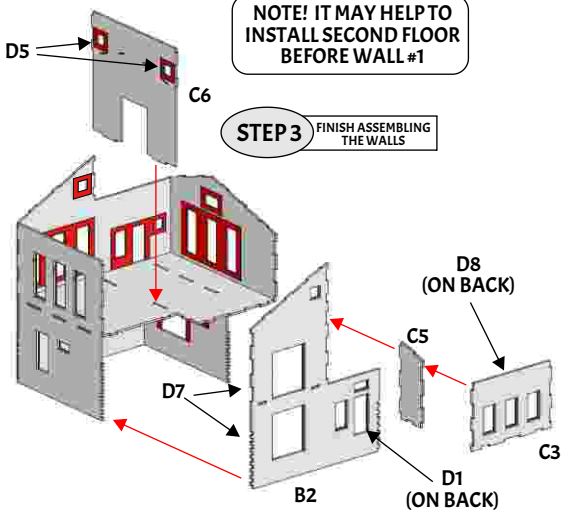

STEP 4 ASSEMBLE THE BASE FLOOR

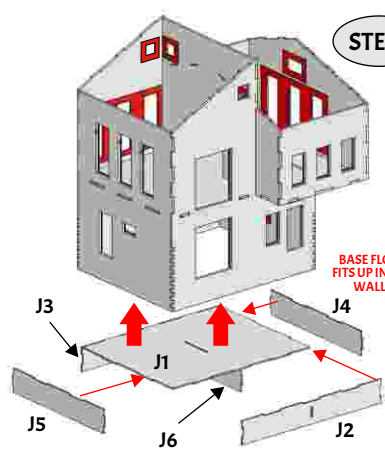

STEP 5 TYPICAL WINDOW, DOOR ASSEMBLY

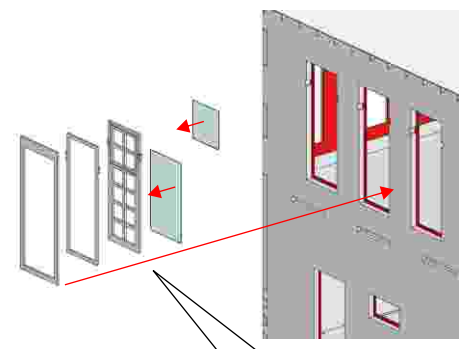

PIVOTING WINDOW FRAME CAN BE CAREFULLY TILTED OPEN

STEP 6 FIRST FLOOR ENTRY

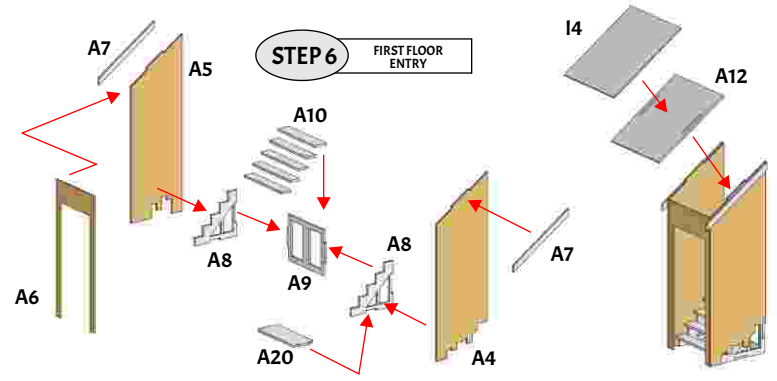

STEP 7 ASSEMBLE THE DECK

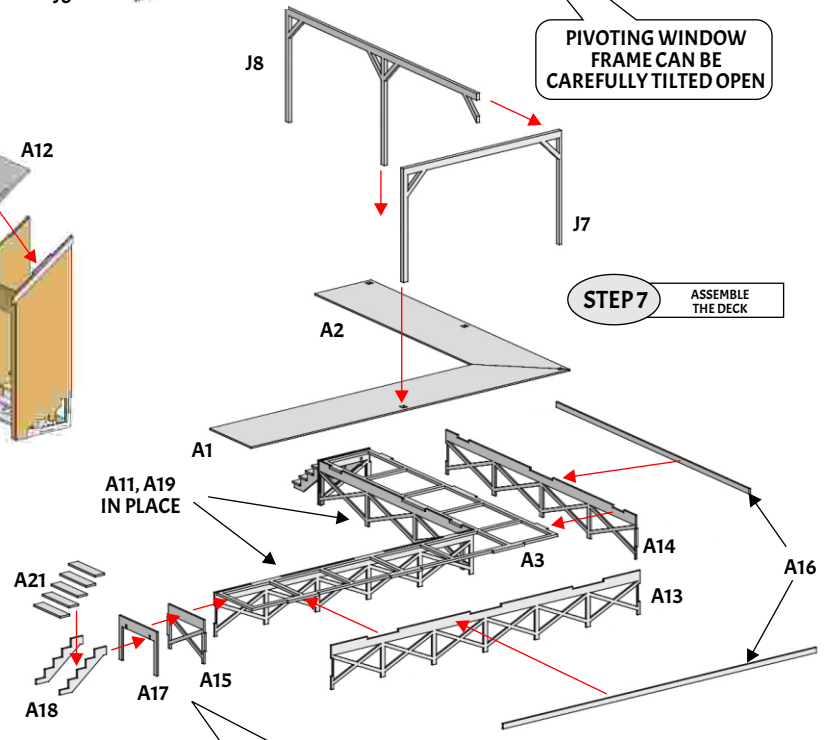

SAME ASSEMBLY ON OPPOSITE END OF DECK

STEP 8 ASSEMBLE THE REAR STEPS

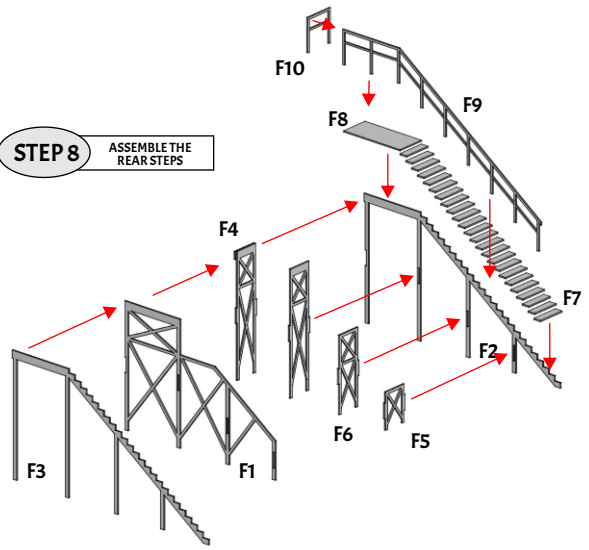

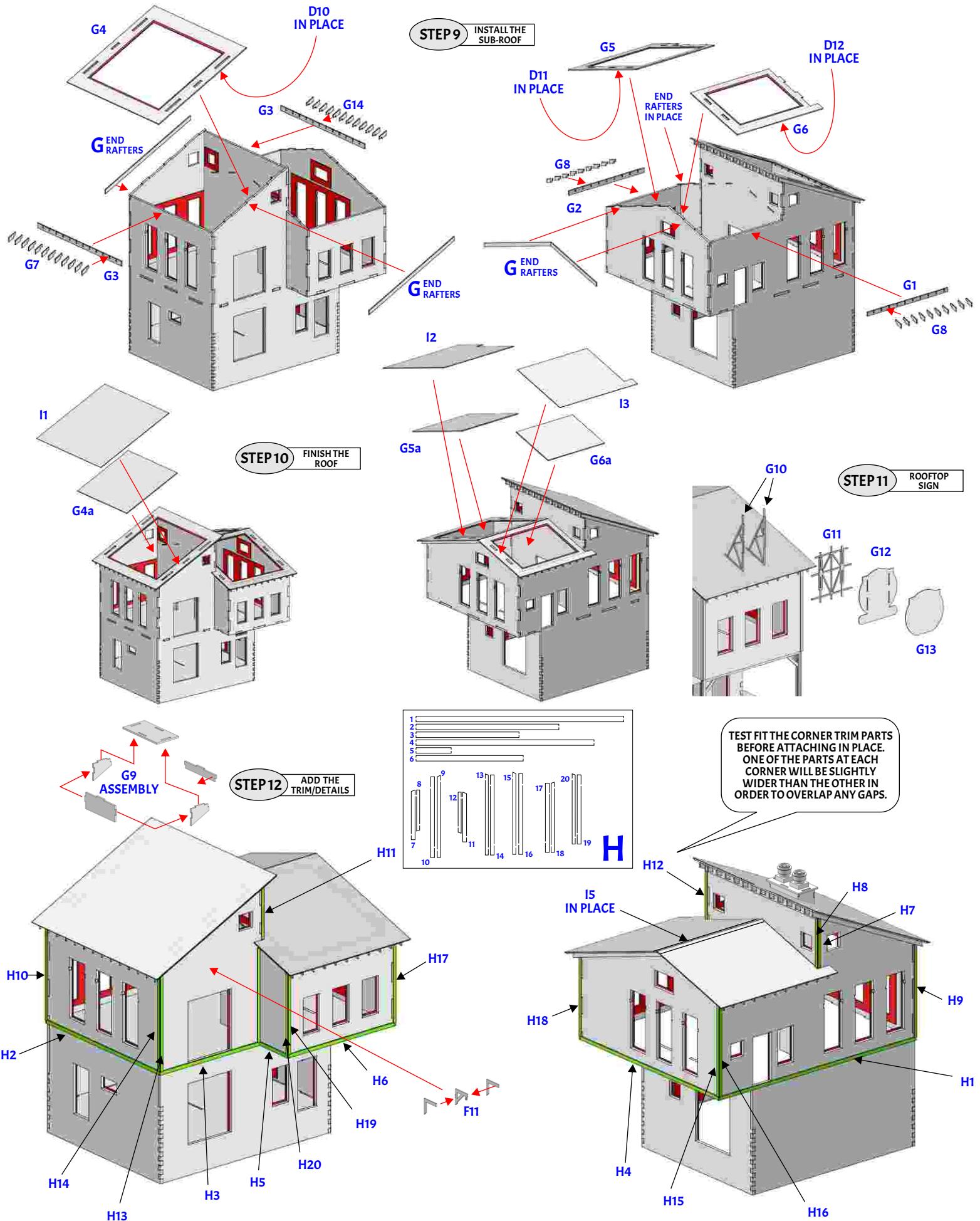

Paint Colors for Val U Oil

Material List, Order, Paint Mixing Ratios and Instructions:

All paint colors except for the primers and the clear blue for the tops of the oil drums are from Vallejo Paints.

1) Primer:

- ACE 12 oz. spray can of Interior/Exterior Chocolate Brown Gloss Enamel #17012

Several coats of the primer were used to paint the entire inside and outside of the building after it was assembled.

2) 2nd Floor Wood-Tone Colors Under the Siding:

- Old Wood 310
- New Wood 311
- Cork Brown 70.843

Each of these 3 colors were lightly applied, (in the order listed), in the direction of the grain, then lightly scuffed with 220 grit sandpaper to give the underlying appearance of aged wood.

3) 2nd Floor Siding and Trim Colors:

- 4x Dead White 72.001
- 2x Sky Gray 70.989
- 1x Green 308

After mixing each of the 3 colors to the proportions listed above, the resulting mint green color was lightly applied in the direction of the grain, then lightly scuffed with 220 grit sandpaper to reveal much of the underlying appearance of the “aged wood” applied in the previous step.

Once dry, a lightly dry-brushed coat of Green 308 was applied, followed by a lightly dry-brushed coat of Flat Brown 70.984, then topped with a light dry-brushing of the mint green color.

Lastly, a final light scuffing with 220 grit sandpaper to get the desired “weathered paint” appearance.

4) Building Brick Colors:

- Flat Brown 70.984
- Burnt Cad Red 70.814
- Light Rust301
- Black 72.051
- Dead White 72.001

[See instructions for painting aged brick on Showcase Miniatures website.](#)

5) 1st Floor Stucco Color – Base Coat:

- 5x Dead White 72.001
- 4x Cork Brown 70.843
- 2x Golden Yellow 70.948

After mixing each color of the 3 colors to the proportions listed above, the resulting cream color was carefully applied to the stucco, carefully avoiding getting any of it on the bricks.

6) 1st Floor Stucco Color – Top Coat:

- 20x Dead White 72.001
- 5x Cork Brown 70.843
- 1x Golden Yellow 70.948

After mixing each color of the 3 colors to the proportions listed above, the resulting lighter cream color was lightly applied to the stucco, again carefully avoiding getting any of it on the bricks.

Once dry, the stucco areas were lightly scuffed with 220 grit sandpaper, revealing trace amounts of the underlying darker cream color.

Paint Colors for Val U Oil

7) Rooftops:

PAINT:

- Cold Gray 72.050
- Sky Gray 70.989
- Dark Rust 302
- Flat Brown 70.984
- Light Rust 301

BRAGDON ENTERPRISES WEATHERING POWDERS:

- Light, Medium and Dark Rust

After covering the entire surface with the Cold Gray color, each of the other colors listed above were lightly dry-brushed with an emphasis of where rust would normally accumulate on the panels.

Once dry, several of the Bragdon Enterprises rust-colored weathering powders were applied to give the rust on the rooftops a “dead-flat” appearance.

8) 55 Gallon Drums:

- Krylon 12 oz. spray can of Color Master Flat White #51502
- Walther's Solvaset 904-470
- Tamiya Clear Blue X-23

After priming the drums flat white, the decals were applied using Solvaset to get them wrapped tightly around the drums.

Once the decals were dry, two thin coats to the clear blue color were applied to the tops of the drums.