

**PREPARE THE POWER CHASSIS**

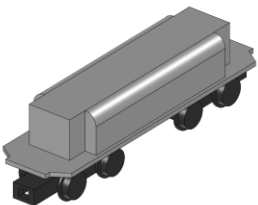

THIS TROLLEY KIT IS POWERED BY THE KATO POWERED MOTORIZED CHASSIS. (NOT INCLUDED). THIS CHASSIS COMES IN 3 DIFFERENT VERSIONS WITH THE DESIGN OF THE TRUCK SIDE FRAMES BEING THE ONLY DISTINGUISHING DIFFERENCE.

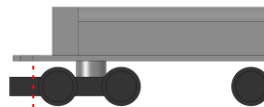

THERE ARE SEVERAL DIFFERENT BUILD CONFIGURATIONS FOR THE TROLLEY. IF THE "COW CATCHER" ATTACHMENTS ARE USED IN THE DOWN POSITION THE COUPLER BOXES MUST BE CUT OFF FOR CLEARANCE.

**KATO POWERED CHASSIS**

KATO 11-105  
KATO 11-106  
KATO 11-107

**\*NOT INCLUDED IN KIT\***

WE RECOMMEND USING MICRO-TRAINS LONG "T" SHANK COUPLERS.

001 30 014

(1130)

**(NOT INCLUDED)**

IF INSTALLING LIGHTING KIT DRILL OUT BEZEL OPENING

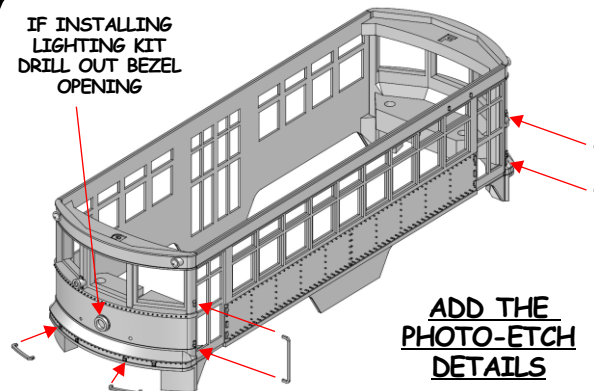

**ADD THE PHOTO-ETCH DETAILS**

ADD PHOTO-ETCH DETAILS TO THE SHELL ASSEMBLY USING SUPER GLUE.



CUT TO FIT IN SHELL ASSEMBLY

THE FRAME ON THE KATO POWER UNIT MUST BE SHORTENED SLIGHTLY ON EACH END TO ALLOW IT TO FIT IN THE COMPLETED TROLLEY SHELL. TEST FIT THE POWER UNIT ONCE THE SHELL ASSEMBLY IS COMPLETE AND CUT TO FIT.

**ASSEMBLE THE ROOF**

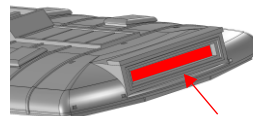

IF INSTALLING LIGHTING KIT DRILL OUT OPENING

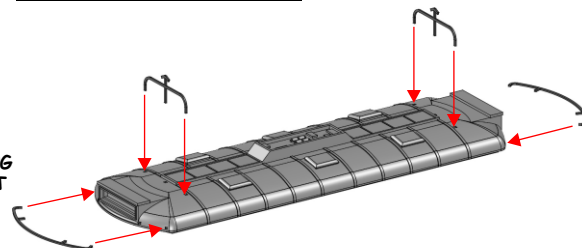

OPTIONAL CATENARY POLES CAN BE ASSEMBLED DEPLOYED OR RETRACTED

LIGHTLY FOLD THE ROOF LADDER OVER THE HANDLE OF A PAINT BRUSH TO GIVE IT SOME CURVATURE.

**PREPARE THE BULKHEADS**

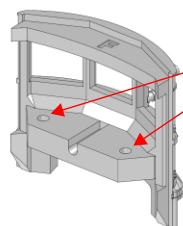

DRILL AND TAP FOR 0-80 SCREW

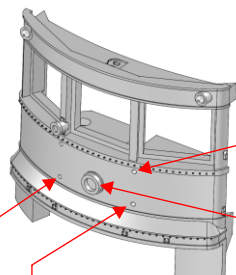

ALTERNATE LOCATION FOR "COW CATCHER". LOCATE TO THIS POSITION IF YOU WANT TO USE COUPLERS.

DRILL THROUGH WITH 1/32" DRILL BIT IF USING OPTIONAL LIGHTING KIT.

ALIGN FRONT "COW CATCHER" PHOTO-ETCHED GRILLE IN PLACE AND MARK HOLE POSITIONS

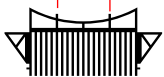

DRILL SIZE REQUIRED IS APPROX. .010"

**FOR BOTH BULKHEADS**

A LIGHTING KIT (LED5010) CAN BE PURCHASED SEPARATELY.

**ASSEMBLE THE SHELL**

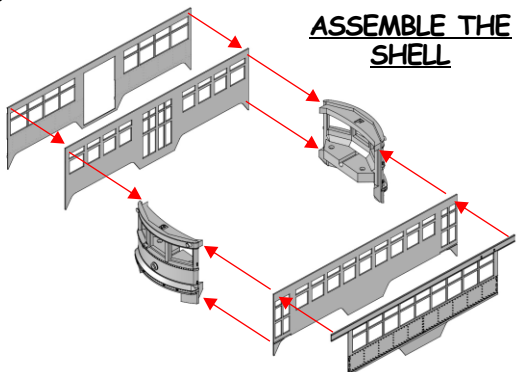

ATTACH LAYERED STAINLESS STEEL SIDES TO THE FRONT AND REAR METAL BULKHEADS USING CA TYPE SUPER GLUE. APPLY GLUE TO INTERIOR JOINT SEAMS FOR EXTRA STRENGTH ONCE THE ASSEMBLY HAS BONDED.

MARK POWER UNIT FRAME THROUGH DRILLED HOLES (4 PLACES)

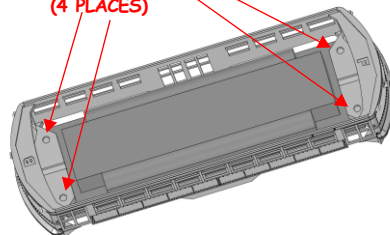

ONCE THE TROLLEY SHELL HAS COMPLETELY CURED, HOLD THE KATO POWER UNIT IN PLACE AND MARK HOLE LOCATIONS FOR DRILLING THROUGH THE POWER UNIT FRAME. DRILL THE MARKED HOLES IN THE KATO FRAME WITH A 3/32" FOR THE SUPPLIED FLUSH MOUNT SCREWS.

**PHOTO-ETCHED DETAILS**

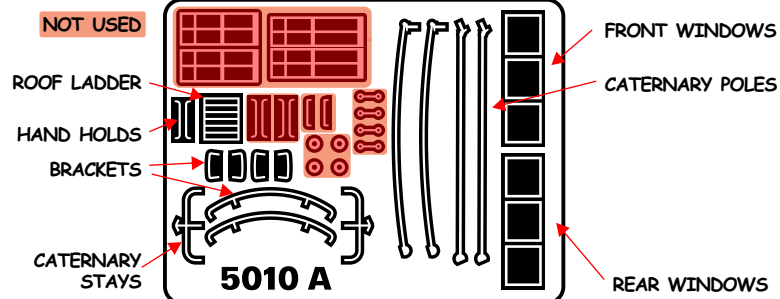

NOT USED

ROOF LADDER

HAND HOLDS

BRACKETS

CATENARY STAYS

**5010 A**

FRONT WINDOWS

CATENARY POLES

REAR WINDOWS

## WINDOW GLAZING



THE FRONT AND REAR WINDOWS ARE BEST PRIMED AND PAINTED WHILE STILL ON THE ETCHED SPRUE. ONCE THEY ARE DRY, ATTACH THEM TO THE INCLUDED GLAZING USING CANOPY GLUE AND THEN GLUE IN PLACE WITH CANOPY GLUE.

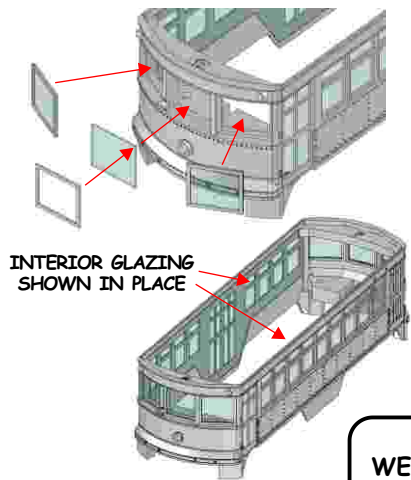
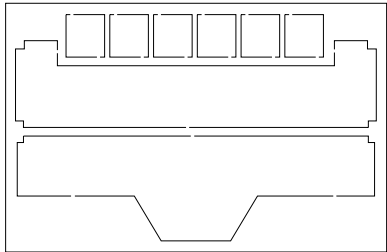

INTERIOR GLAZING SHOWN IN PLACE

WE RECOMMEND USING A PHOTO-ETCH BENDING TOOL TO BUILD THE ETCHED PARTS.

## FINAL ASSEMBLY

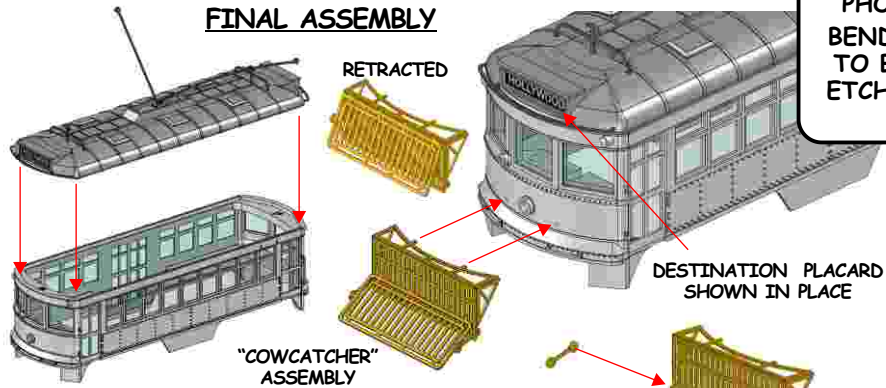

RETRACTED

"COWCATCHER" ASSEMBLY

DESTINATION PLACARD SHOWN IN PLACE

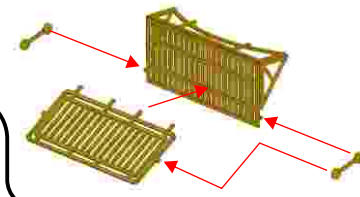

## PAINTING

WE SUGGEST PAINTING THE TROLLEY AFTER THE BODY AND ROOF ASSEMBLIES ARE COMPLETED. USE A GOOD LAQUER BASED PRIMER (WE SUGGEST TAMIYA BRAND WHITE SURFACE PRIMER). THE TROLLEY MODEL IS PAINTED USING MODEL MASTER INTERNATIONAL ORANGE (FS12197) AND INSIGNIA RED (FS 31163). SEE BACK OF BOX LABEL FOR DETAILS

DOOR MASKS ARE PROVIDE FOR AID IN PAINTING.

THE KATO POWER UNIT CAN ALSO BE MASKED AND PAINTED BLACK ABOVE THE TRUCKS TO MAKE IT LESS VISIBLE INSIDE THE TROLLEY.

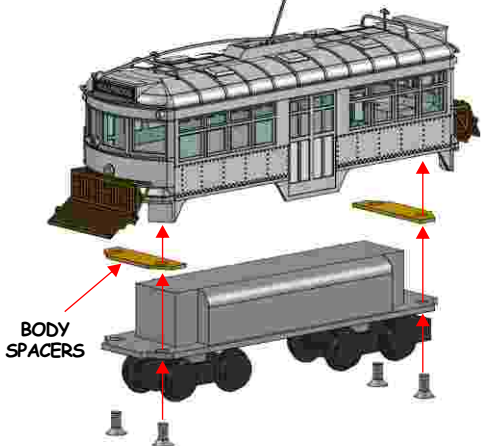

BODY SPACERS

## PARTS

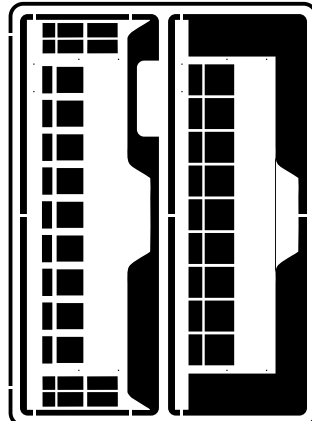

STAINLESS STEEL SIDE RIGHT

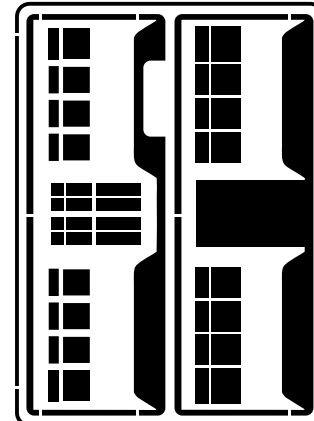

STAINLESS STEEL SIDE LEFT

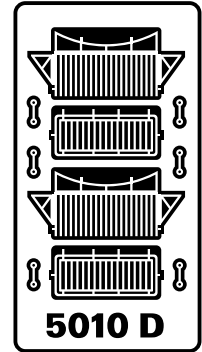

5010 D

COWCATCHER BRASS ETCH

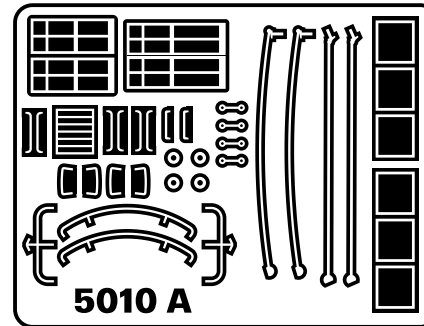

STAINLESS STEEL DETAILS

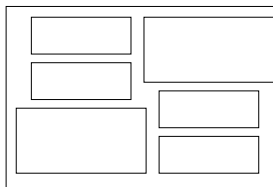

DOOR PAINTING MASK

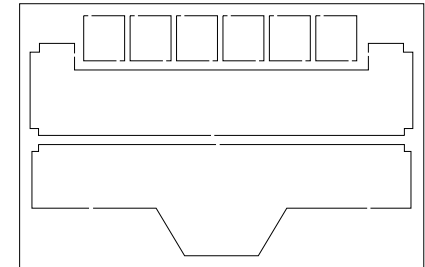

WINDOW GLAZING



SIGN GRAPHIC

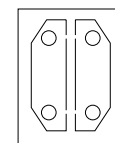

BODY SPACERS



DESTINATION PLACARDS

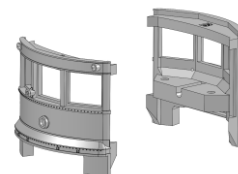

CAST METAL BULKHEADS B AND F

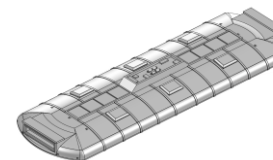

CAST RESIN ROOF

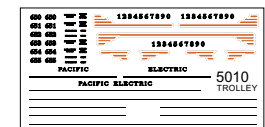

MICROSCALE DECALS

0-80 SCREWS

**SHOWCASE**  
Miniatures