

PARTS

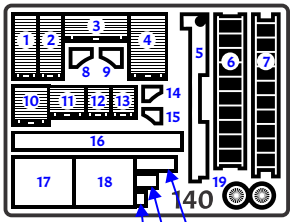

20 21 22

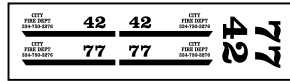
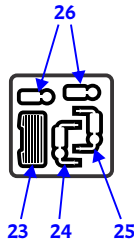

DECAL
(ON WHITE PAPER)



WINDSHIELD

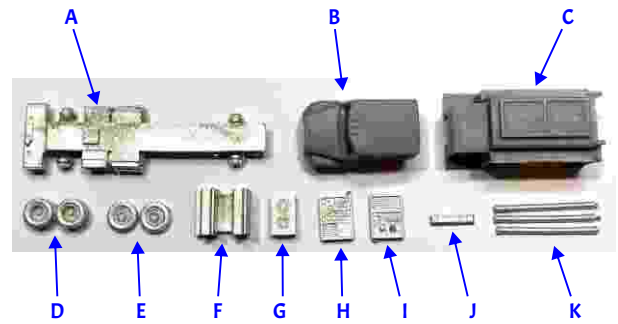

D E F G H I J K

ASSEMBLY

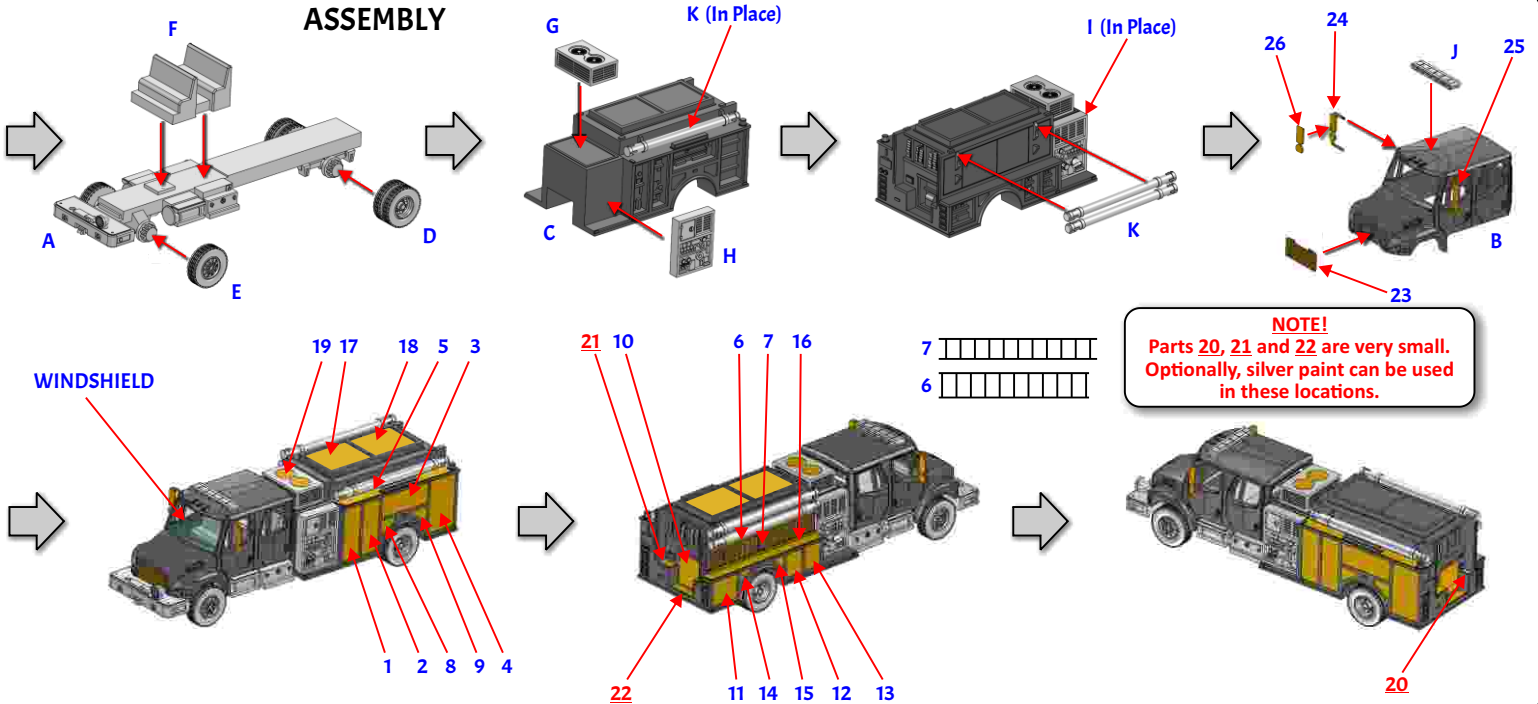

NOTE!
Parts 20, 21 and 22 are very small.
Optionally, silver paint can be used
in these locations.

FINISHING

PLEASE !! READ THROUGH ALL OF THE INSTRUCTION STEPS BEFORE STARTING. THIS KIT CAN BE BUILT IN DIFFERENT CONFIGURATIONS SO THESE INSTRUCTIONS ARE GUIDELINES TO SHOW YOU WHERE THE PARTS ARE PLACED.

ALL PARTS MAY BE PAINTED INDIVIDUALLY BEFORE ASSEMBLY OR, CAN BE BUILT INTO SUB-ASSEMBLIES AND THEN PAINTED. WE RECOMMEND THAT YOU WASH ALL METAL PARTS (EXCEPT PHOTO-ETCH PARTS) IN EITHER WARM, SOAPY WATER OR ALCOHOL (OUR PREFERENCE). RESIN PARTS SHOULD BE WASHED IN WARM, SOAPY WATER. ALLOW ALL PARTS TO DRY COMPLETELY BEFORE PAINTING OR ASSEMBLING.

WE GENERALLY RECOMMEND USING SUPER GLUE FOR ASSEMBLY. PSA (PRESSURE SENSITIVE ADHESIVE - CANOPY GLUE) WAS USED TO ATTACH THE PHOTO ETCH PARTS ON THE BODY AND WINDSHIELD TO THE MODEL. THESE PARTS WERE NOT PAINTED AND APPLIED LAST, AFTER ALL OTHER FINISH WAS COMPLETE. THE VACUUM FORMED WINDSHIELD WAS CUT OUT AROUND IT'S EDGES USING A SHARP HOBBY KNIFE.

WE RECOMMEND A GOOD LAQUER BASED WHITE PRIMER FOR METAL AND RESIN PARTS. OUR RECOMMENDED PRIMER IS TAMIYA BRAND SURFACE PRIMER. EITHER ACRYLIC OR ENAMEL PAINTS CAN BE USED ONCE THE ASSEMBLIES ARE PRIMED. WE USED TESTOR'S SPRAY ENAMEL ON THIS KIT.

THE BODY AND CAB WERE PAINTED WITH TESTOR'S FLAT RED. METAL PARTS (EXCEPT PARTS K) WERE SPRAY PAINTED WITH TESTOR'S CHROME. PARTS K WERE PAINTED WITH TESTOR'S FLAT BLACK. THE ROOFTOP FLASHER WAS PAINTED WITH VALLEJO CLEAR YELLOW OVER THE WHITE PRIMER.

WHEN COMPLETELY DRY, ALL PARTS WERE GIVEN A COAT OF TESTOR'S DULLCOTE. THIS LEAVES A 'TOOTH' TO ACCEPT DRY PASTEL POWDERS APPLIED WITH A FINE BRUSH IN RECESSED GROOVES AND SEAMS. THIS WILL SIMULATE DEPTH ON THE FINISHED MODEL.

FINALLY, THE ENTIRE MODEL WAS SEALED WITH A CLEAR, SEMI-GLOSS SPRAY FINISH. WATERSLIDE DECALS WERE APPLIED AFTER THIS AND RE-SEALED WITH SEMI-GLOSS IF NECESSARY. THE WATERSLIDE DECALS ARE NOT PRE-CUT AND MUST BE CUT AS CLOSE AS CLOSE TO THE EDGE OF THE GRAPHIC AS POSSIBLE. SOAK 30-45 SECONDS FACE-UP, FLOATING ON THE SURFACE OR ROOM TEMP. WATER.