

PARTS

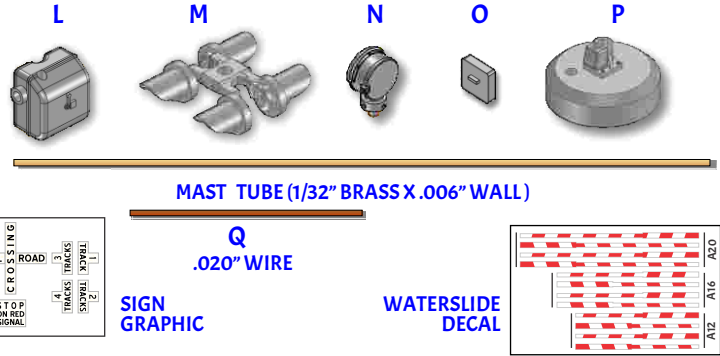

WE HIGHLY RECOMMEND THAT YOU READ THROUGH THE ASSEMBLY STEPS AND STUDY THE DIAGRAMS AND NOTES CLOSELY TO FAMILIARIZE YOURSELF WITH OUR SUGGESTED ASSEMBLY METHOD.

FIG. 1

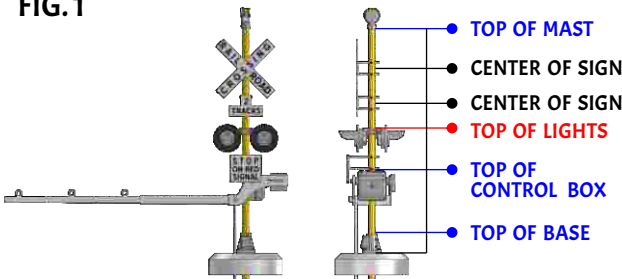

THIS DRAWING IS N SCALE FOR MEASUREMENTS.

GETTING STARTED

THIS GRADE CROSSING SIGNAL CAN BE BUILT WITH OR WITHOUT THE CROSSING ARM AND CAN BE LIGHTED USING 402 SIZE LEDs (SOLD SEPARATELY).

THE CROSSING ARM CAN BE ANIMATED USING A SUPPLIED PUSH-ROD ALONG WITH AN APPROPRIATE ANIMATING CIRCUIT (NOT INCLUDED).

LAY THE BRASS MAST TUBE DIRECTLY ON THE SUPPLIED SCALE DRAWING (FIG. 1) AND MARK THE LOCATIONS FOR THE TOP OF THE CONTROL BOX, LIGHTS, SIGN CENTERS AND BASE (FIG. 2)

PARTS AND ASSEMBLIES CAN BE ATTACHED TO THE MAST WITH TINY DROPS OF CANOPY GLUE AND PERMANENTLY ATTACHED USING TINY DROPS OF CA GLUE TO HOLD THEM IN PLACE.

SEE "MICRO-GLUEING" BELOW

FIG. 2

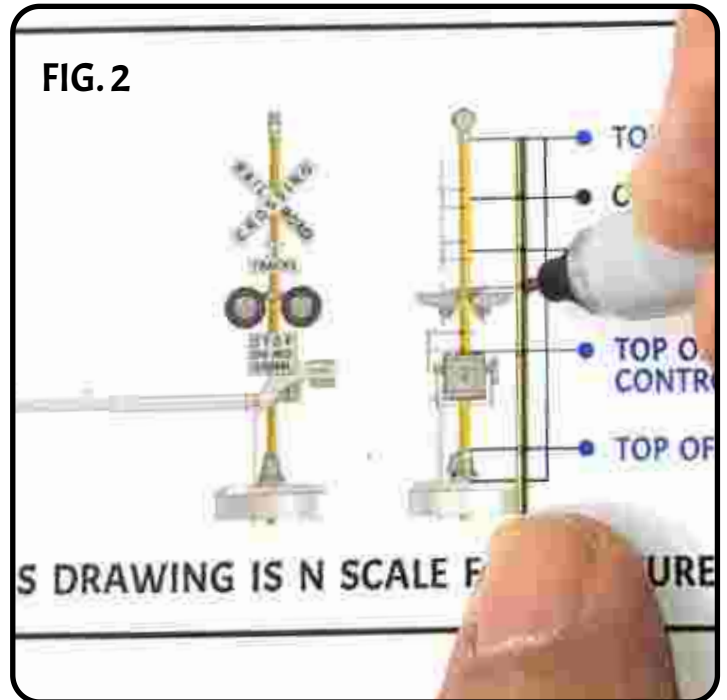

MICRO-GLUEING

APPLY SEVERAL DROPS OF SUPER GLUE TO A PLASTIC SURFACE FOR A RESERVOIR AND USE A SHORT LENGTH OF FINE WIRE TO DIP OUT A TINY DROP OF GLUE (FIG. 3).

FIG. 3

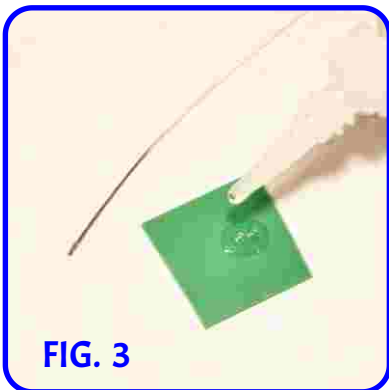

STEP 1 IF NECESSARY, CAREFULLY STRAIGHTEN AND ALIGN THE LIGHT FIXTURE (N) THEN DRILL THROUGH THE BACK WITH A .02" OR .025" DRILL TO ALLOW THE LED WIRES TO PASS THROUGH THE FIXTURE AS INDICATED. USE CANOPY GLUE TO HOLD THE LEDs IN THE FIXTURE HEAD,

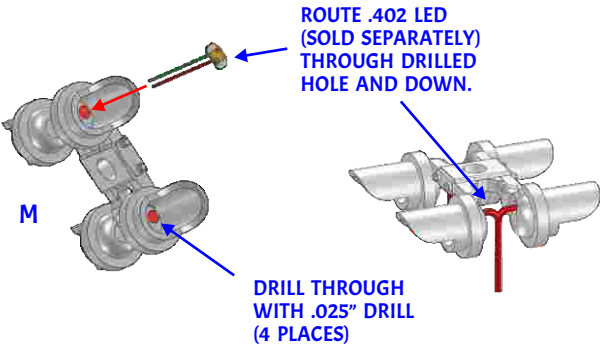

STEP 2 FIRST ATTACH THE CONTROL BOX AT THE PREVIOUSLY MARKED LOCATION ON THE MAST USING SUPER GLUE. THEN SLIDE THE LIGHT FIXTURE ASSEMBLY DOWN THE TUBE TO ITS PREVIOUSLY MARKED LOCATION - ALIGN PER THE DRAWING AND GLUE WITH SUPER GLUE. ONCE GLUED, ATTACH THE HOOD SHIELDS (D) TO THE LIGHT FIXTURE AS SHOWN

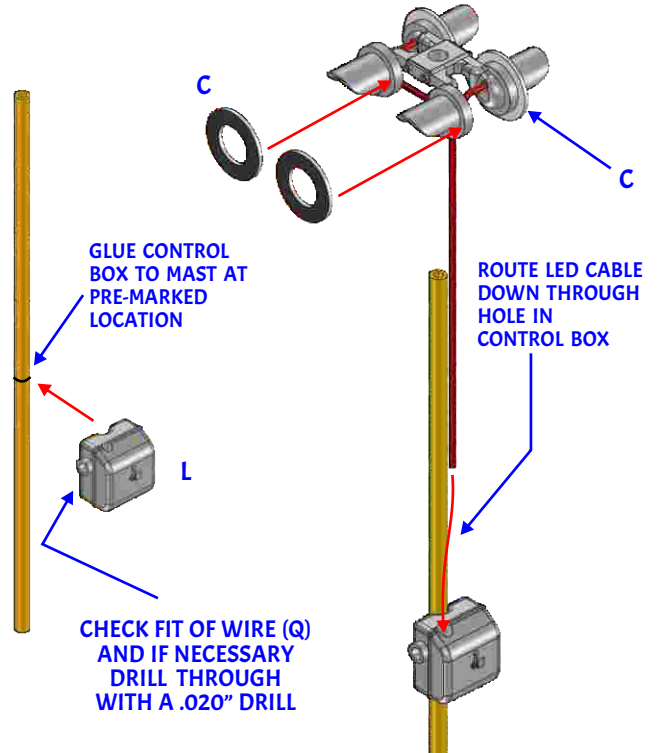

NOTE:
BEFORE REMOVING THE ARM MOUNTING BRACKET (F) FROM THE ETCHED SPRUE, CHECK THE HOLES WITH A .020" DRILL. IF NECESSARY TO DRILL IT OUT, DO IT BEFORE REMOVING FROM THE ETCHED FRET WHILE LAYING FLAT ON THE DESKTOP.

STEP 3 ALIGN AND GLUE THE SIGNAL BELL (N) TO THE TOP OF THE MAST.

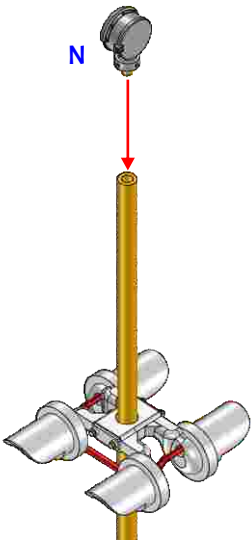

STEP 4 CHOOSE THE CROSSING ARM LENGTH YOU PREFER - 12', 16' OR 20' - AND ASSEMBLE AS SHOWN BELOW WITH SUPER GLUE. PAINT THE ARM WHITE IN PREPARATION FOR THE DECAL.

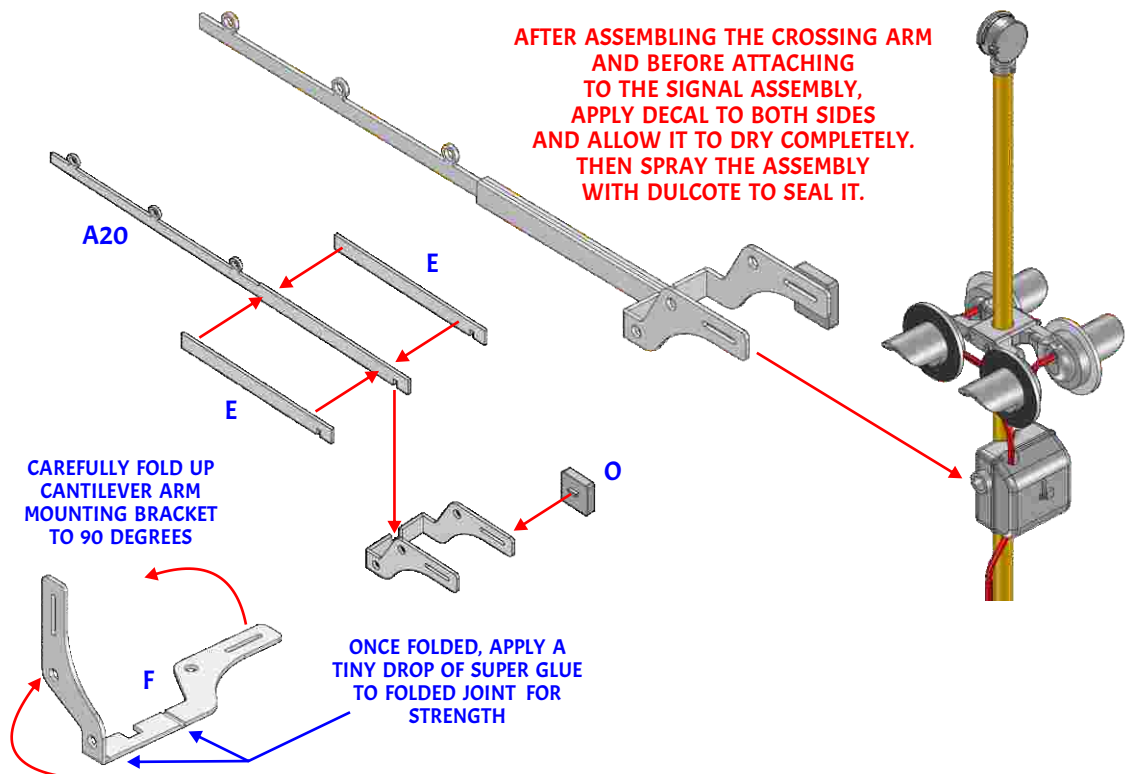

NOTE:
REMOVE THE PUSH-ROD (H) FROM THE ETCHED FRET AND, REFERRING TO STEP 6, WORK IT INTO THE PUSH-ROD HOLE ON THE ARM MOUNTING BRACKET (F). IF NECESSARY, OPEN THE HOLE WHILE STILL ON THE FRET AND LAYING FLAT ON THE DESKTOP.

STEP 5 HOLD THE CROSSING ARM ASSEMBLY IN PLACE AND SLIDE THE PIVOT SHAFT THROUGH THE HOLES IN THE ARM BRACKET AND THROUGH THE CONTROL BOX. ONCE THE CROSSING ARM ASSEMBLY IS IN PLACE, CUT THE SHAFT TO LENGTH LEAVING ABOUT .02" PROTRUDING FROM EACH SIDE.

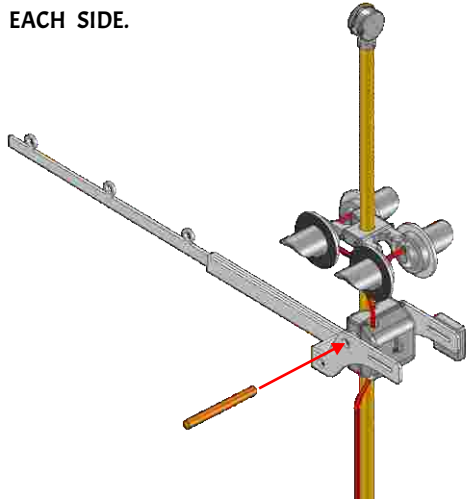

STEP 6 TO ANIMATE THE CROSSING ARM, INSERT THE PUSH-ROD (H) INTO THE PUSH-ROD HOLE FROM THE INSIDE AT AN ANGLE AND PIVOT IT DOWN TO LOCK IN PLACE.

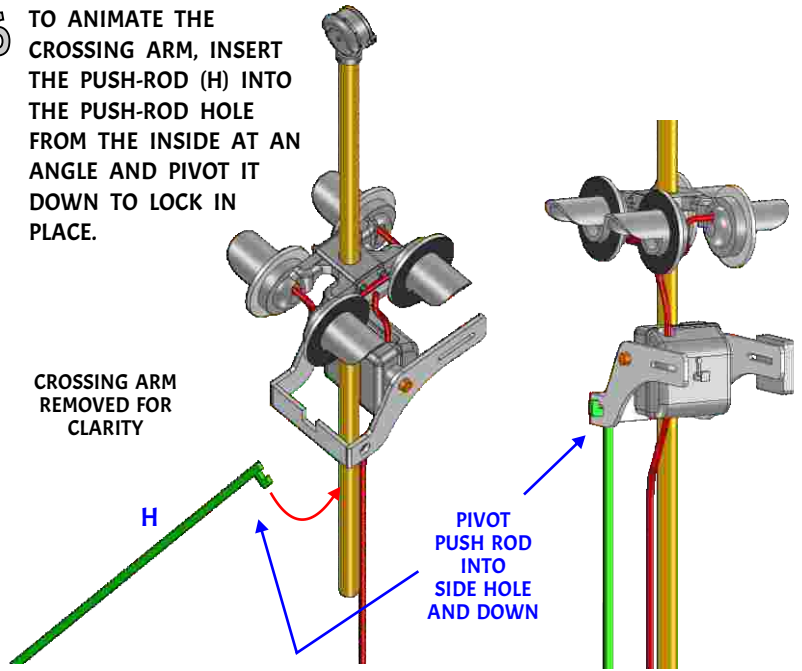

STEP 7 CAREFULLY FEED THE PUSH-ROD AND LED CABLE DOWN INTO THE BASE (P). SLIDE THE BASE UP TO THE PREVIOUSLY MARKED LOCATION.

THIS BASE IS DESIGNED TO WORK WITH OUR MAGNETIC BREAK AWAY SIGNAL BASES (SKU#2365) BUT NOT REQUIRED

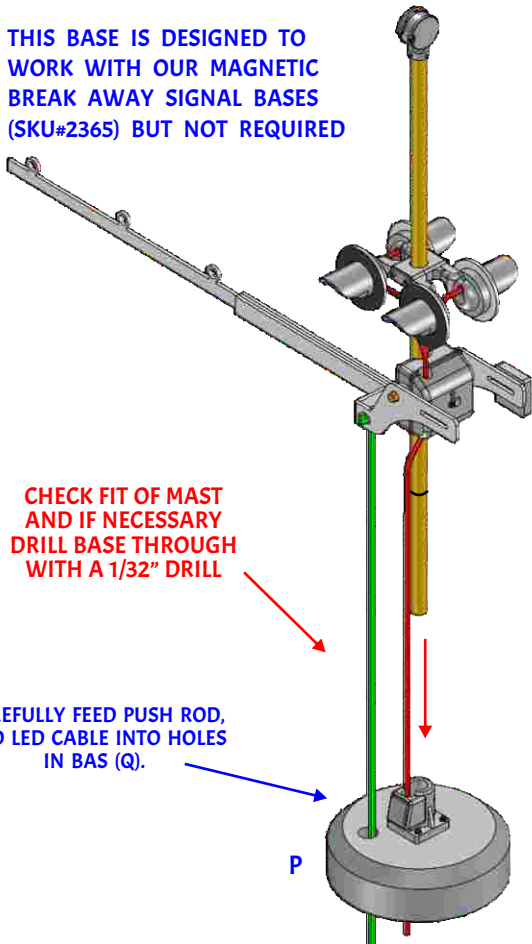

STEP 8 CAREFULLY FOLD THE SIGN BRACKETS AS SHOWN. THEY CAN BE HELD IN PLACE WITH TINY DROPS OF CANOPY GLUE APPLIED EITHER TO THEIR MAST LOCATION OR TO THE BRACKETS THEMSELVES. FOR BEST RESULTS, APPLY THE SIGN LAST, ONCE THE BRACKETS HAVE BEEN GLUED IN PLACE WITH SUPER GLUE. BOTH ETCHED SIGNS AND PRINTED SIGNS ARE INCLUDED FOR YOUR CHOICE. THE SIGN CAN ALSO BE HELD IN PLACE USING CANOPY GLUE AND THEN FINAL GLUED WITH THICK SUPER GLUE (FOR THE PAPER SIGNS).

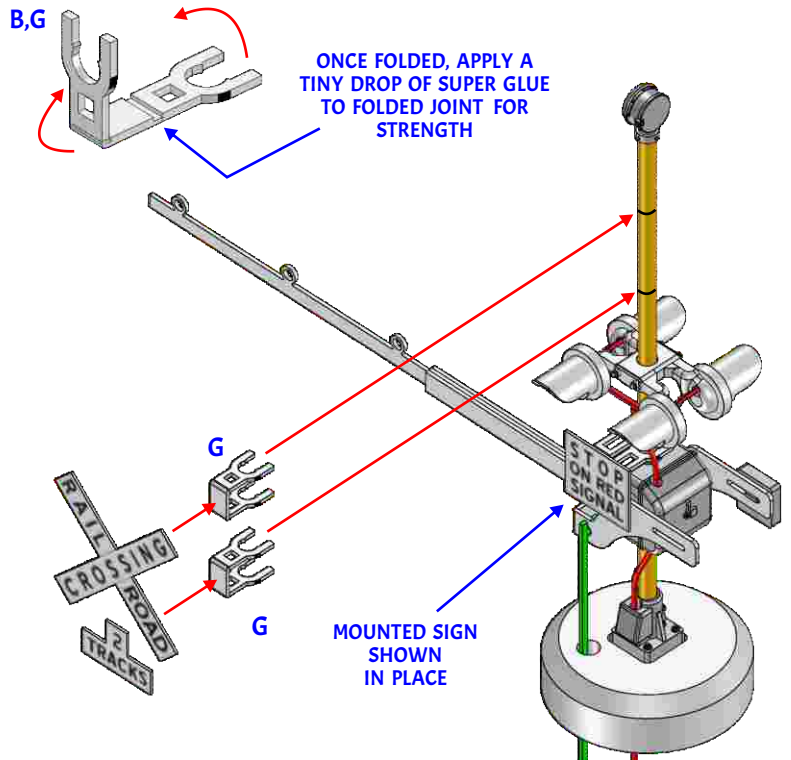

STEP 9 PAINTING AND FINISHING

WE RECOMMEND PAINTING THE MODEL 10 CROSSING SIGNAL AFTER COMPLETION EXCEPT FOR THE CROSSING ARM ASSEMBLY. IT SHOULD BE PAINTED BEFORE ATTACHING TO THE MAST ASSEMBLY.

WE RECOMMEND AN ALUMINUM SILVER PAINT FOR THE OVERALL COLOR WITH FLAT BLACK HOODS AND HOOD SHIELDS. TO PREVENT PAINT COVERING THE ALREADY INSTALLED LEDs, COVER THE WITH A TINY BIT OF CLAY OR MASKING TAPE.

WE HAVE INCLUDED TWO DIFFERENT TYPES OF SIGNS FOR THE SIGNAL - ETCHED STAINLESS SIGNS OR PRINTED PAPER GRAPHICS. EITHER CAN BE USED. WHEN ATTACHING THE PAPER SIGNS TO THE SIGN BRACKETS, HOLD THEM IN PLACE WITH CANOPY GLUE AND, ONCE THEY ARE POSITIONED CORRECTLY, USE THICK SUPER GLUE ON THE BACK TO PERMANENTLY MOUNT THEM. **THIN SUPER GLUE MAY BLEED THROUGH THE PAPER SIGN.**

INSTRUCTIONS ARE SHOWN BELOW FOR USING OUR BREAK-AWAY SIGNAL BASE (SKU#2365) WITH THIS GRADE CROSSING SIGNAL IF YOU DECIDE TO USE THIS.

IF NECESSARY
DRILL WITH 1/16" BIT
AT LEAST 1/16" DEEP
FOR FITTING
MAGNETS
IN BOTH THE BASE
AND SUB-BASE

SUB-BASE

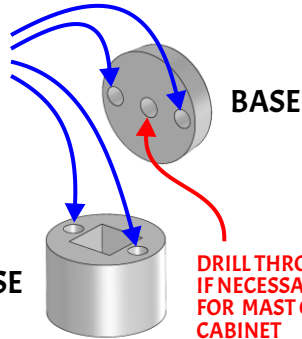

DRILL THROUGH
IF NECESSARY
FOR MAST OR
CABINET

GLUE MAGNETS
IN PLACE IN THE SUB-BASE
USING CA GLUE OR EPOXY

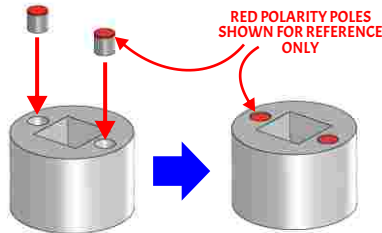

RED POLARITY POLES
SHOWN FOR REFERENCE
ONLY

GLUE MAGNETS IN
PLACE IN THE BASE
TAKING CARE TO
MAKE SURE THE
POLARITY
IS CORRECT

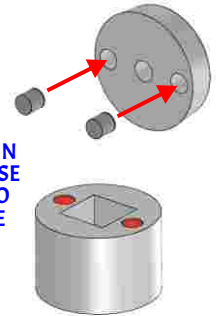

CUT THE MAST/TUBE FLUSH WITH THE BOTTOM OF THE BASE TO ALLOW THE SIGNAL ASSEMBLY TO TIP OVER WITHOUT BEING DAMAGED.

THE SUB-BASE CAN BE MOUNTED AT OR JUST BELOW "GROUND" LEVEL WITH THE BASE SITTING AT "GROUND" LEVEL

WATERSLIDE DECALS:

Visit our painting and finishing tips on our website

WATERSLIDE DECALS ARE NOT PRE-CUT AND MUST BE CUT AS CLOSE TO THE EDGE OF THE GRAPHIC AS POSSIBLE. SOAK 30-45 SECONDS, FACE UP, FLOATING ON SURFACE OF ROOM TEMP. WATER.

SLIDE THE DECAL OFF THE BACKING PAPER ONTO THE SURFACE OF THE PART