

GETTING STARTED

**PLEASE!! READ THROUGH ALL OF THE INSTRUCTION STEPS BEFORE STARTING. THE PARTS ARE DESIGNED TO BE PRECISE FITTING AND SOME ASSEMBLIES BUILD ON PREVIOUS STEPS.**

ALL PARTS MAY BE PAINTED BEFORE ASSEMBLY WHILE THEY ARE STILL ON THEIR SPRUES. ONCE THE WALL PARTS HAVE BEEN PAINTED, THEY CAN BE CUT FROM THE SPRUE. INSTALLING THE WINDOWS AND DOORS AND SOME OF THE TRIM MAY BE ADVANTAGEOUS AT THIS POINT. COMPLETED WALL SECTIONS CAN THEN BE ASSEMBLED PER THE INSTRUCTIONS.

1. BEFORE YOU BEGIN CONSTRUCTION, TAKE THE TIME TO BECOME FAMILIAR WITH THE PARTS AND INSTRUCTIONS. THE PARTS ARE COLOR CODED TO MAKE IT EASIER TO FIND THEM ON THE SPRUES.
2. FOLLOWING THE INSTRUCTIONS IN ORDER WILL AID IN GETTING PARTS CORRECTLY POSITIONED - SOME PARTS RELY ON ACCURATE PLACEMENT OF A PRECEDING PART TO ALLOW IT TO FIT CORRECTLY.
3. THE WINDOWS AND DOORS HAVE DOUBLE STICK ADHESIVE BACKING TO ALLOW THEM TO BE APPLIED TO THIN, CLEAR PLASTIC (NOT SUPPLIED). CUT THEM OFF THE PLASTIC WITH A HOBBY KNIFE AND THEN ASSEMBLE. WE RECOMMEND THAT YOU PAINT THE WINDOWS AND DOORS WHILE THEY ARE STILL ATTACHED TO THE FRET. SPRAY PAINT WORKS BEST FOR THIS.
4. THIS REVISION INCORPORATES SOME CHANGES IN FRED'S ONE STOP. WE HAVE COMPLETELY UPDATED THE WINDOW AND DOOR ASSEMBLIES. PLEASE GO TO PAGES 5 AND 6 FOR DETAIL ON WINDOW ASSEMBLY AND PLACEMENT. WE RECOMMEND VALLEJO BRAND ACRYLIC PAINTS FOR THIS KIT.

AS WITH ALL OF OUR KITS WE HOPE YOU ENJOY BUILDING AND FINISHING THIS MODEL. PLEASE LET US KNOW OF ANY SUGGESTIONS OR IDEAS YOU MIGHT HAVE TO IMPROVE OUR KITS.

PLEASE VISIT OUR WEBSITE AT WWW.SHOWCASEMINIATURES.NET TO ENSURE THAT YOU HAVE THE LATEST VERSION OF THE ASSEMBLY INSTRUCTIONS.

PARTS FRETS  
USE THE COLOR DRAWINGS TO HELP LOCATE THE PARTS.

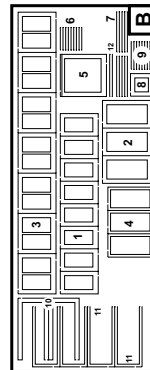
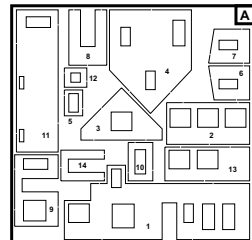
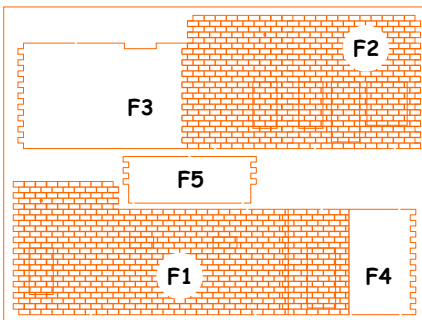
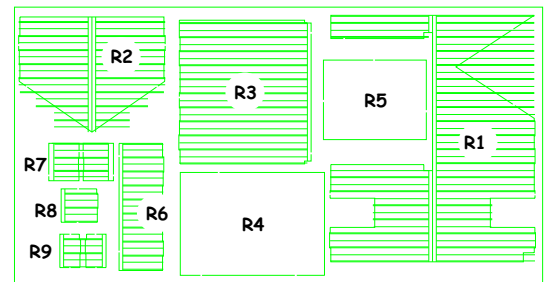
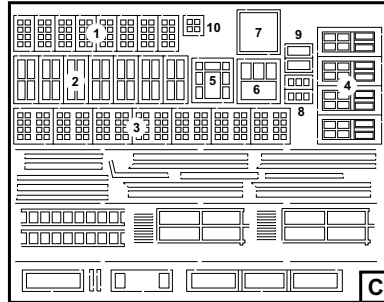
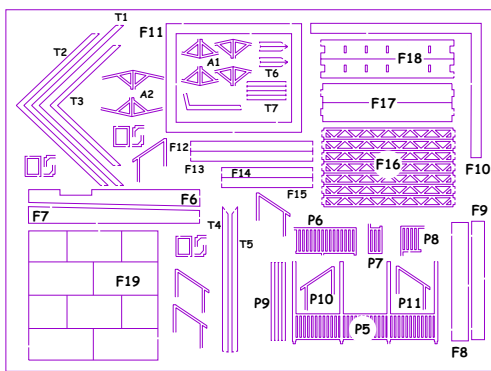
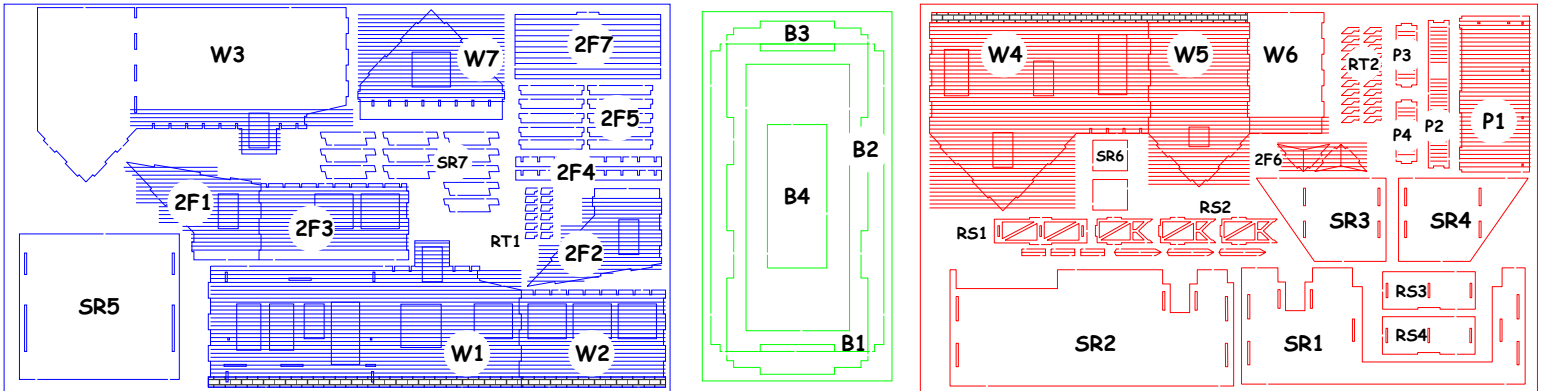

Clean metal parts in warm soapy water and thoroughly dry before painting. Soda machines must be painted white (at least where the decal will be placed). Waterslide decals are not pre-cut and must be cut as close to the edge of the graphic as possible. Soak each cut decal for 30-45 seconds, face up, floating on surface of room temp. water.

PAPER GRAPHICS  
METAL DETAILS

STEP 1 - BUILD THE BASE

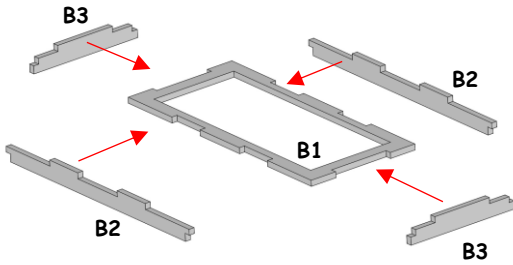

USE THE BASE AS BOTH A SUPPORT FOR THE MODEL AND A GUIDE FOR ASSEMBLY

STEP 2 - BUILD THE MAIN STRUCTURE

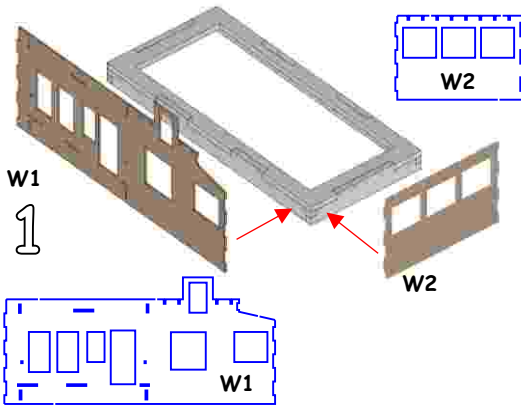

W1  
1

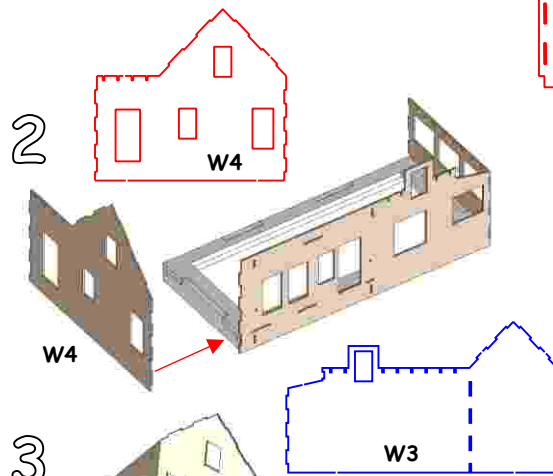
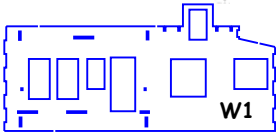

2

3

NOTE: DO NOT GLUE HERE

NOTE: GLUE ALONG BOTTOM EDGE ONLY

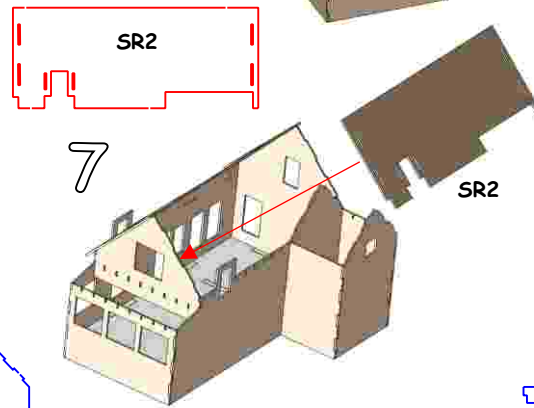

7

8

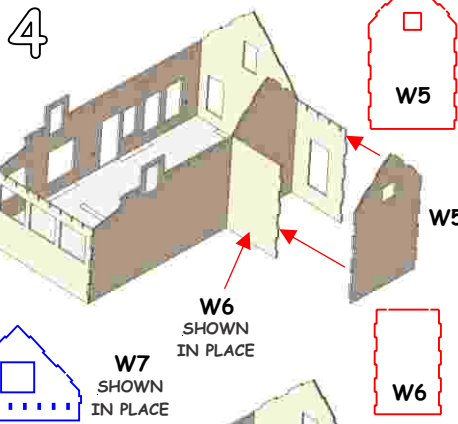

4

5

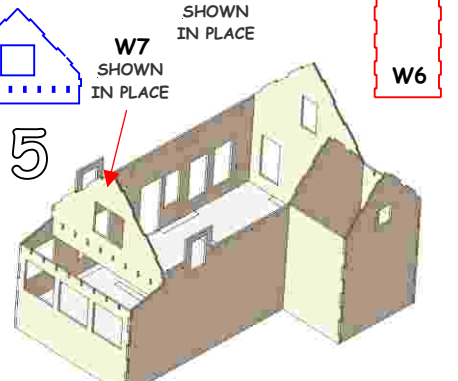

6

8

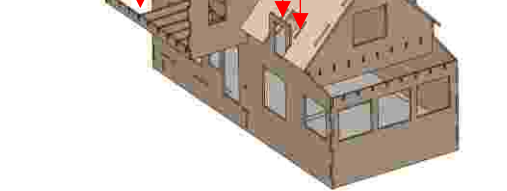
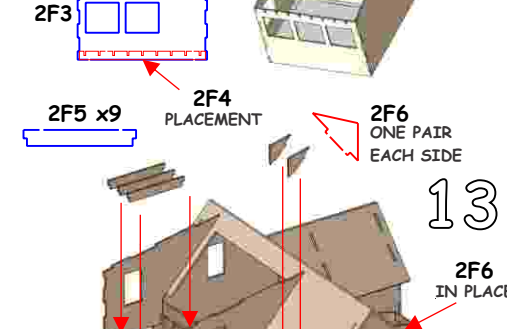
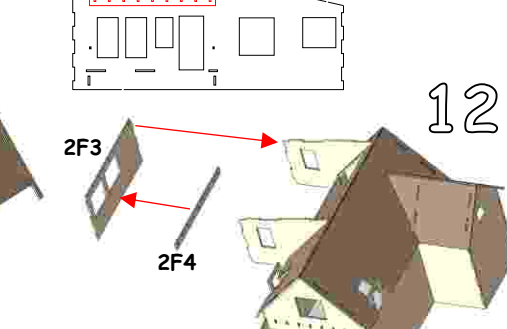
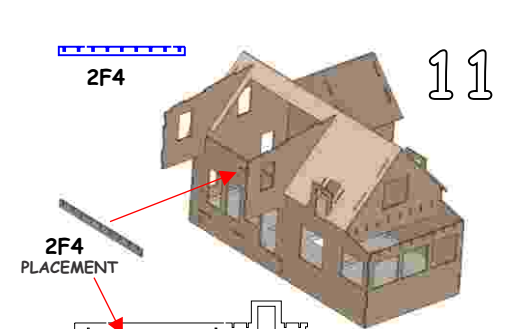
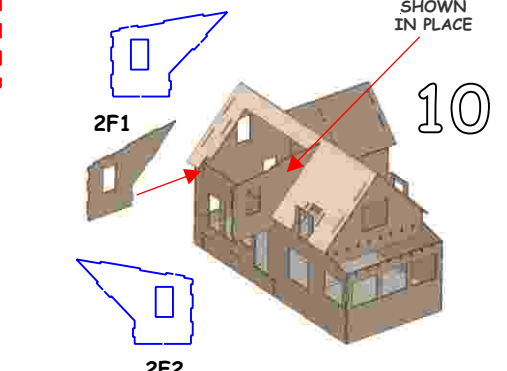
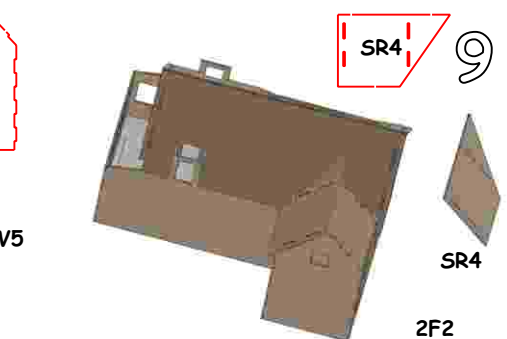

SR4

9

SR4

2F2 SHOWN IN PLACE

10

2F1

2F2

2F4

11

2F4 PLACEMENT

12

2F3

2F4

2F3

2F5 x9

2F4 PLACEMENT

2F6 ONE PAIR EACH SIDE

13

2F6 IN PLACE

14

TEST FIT THEN  
PEEL OFF BACKING  
AND APPLY

LIGHTLY SCRIBE CENTERLINE  
WITHOUT CUTTING THROUGH  
WITH KNIFE BLADE TO  
ALLOW THE ROOF SHEET  
TO FOLD

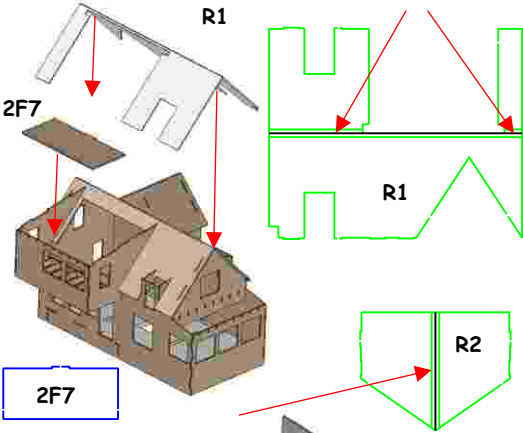

2F7

LIGHTLY SCRIBE CENTERLINE  
WITHOUT CUTTING THROUGH  
WITH KNIFE BLADE TO  
ALLOW THE ROOF SHEET  
TO FOLD

15

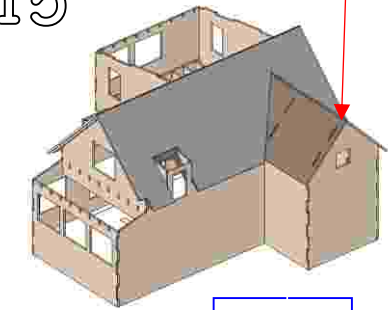

SR5

SR5

16

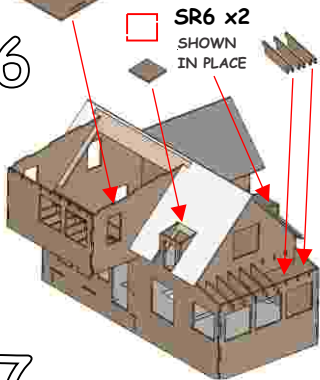

SR6 x2  
SHOWN  
IN PLACE

SR7 x 8

17

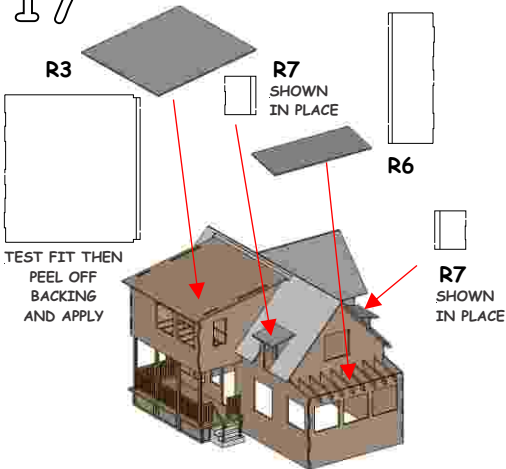

TEST FIT THEN  
PEEL OFF BACKING  
AND APPLY

STEP 3 - BUILD THE PORCH

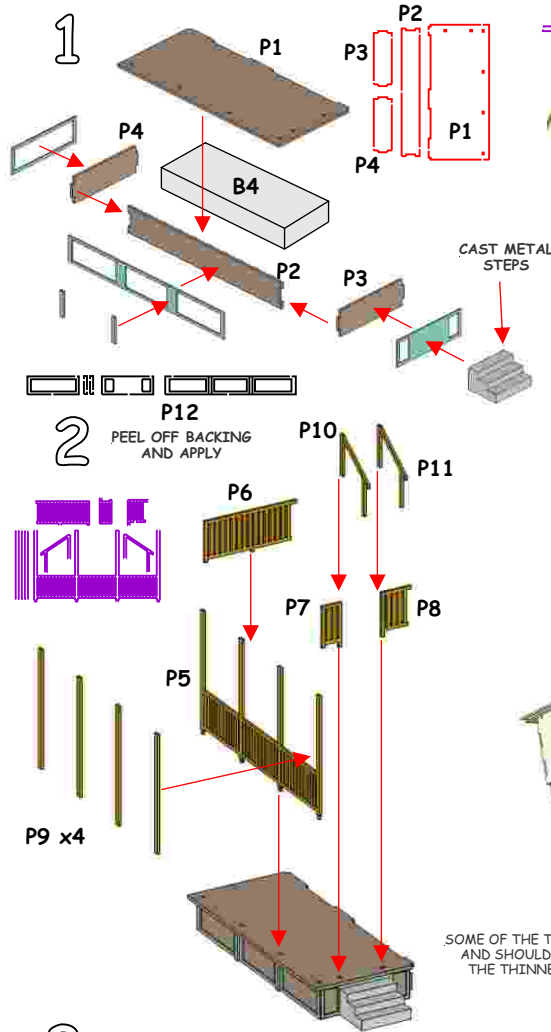

2

PEEL OFF BACKING  
AND APPLY

P9 x4

3

STEP 4 - TRIM

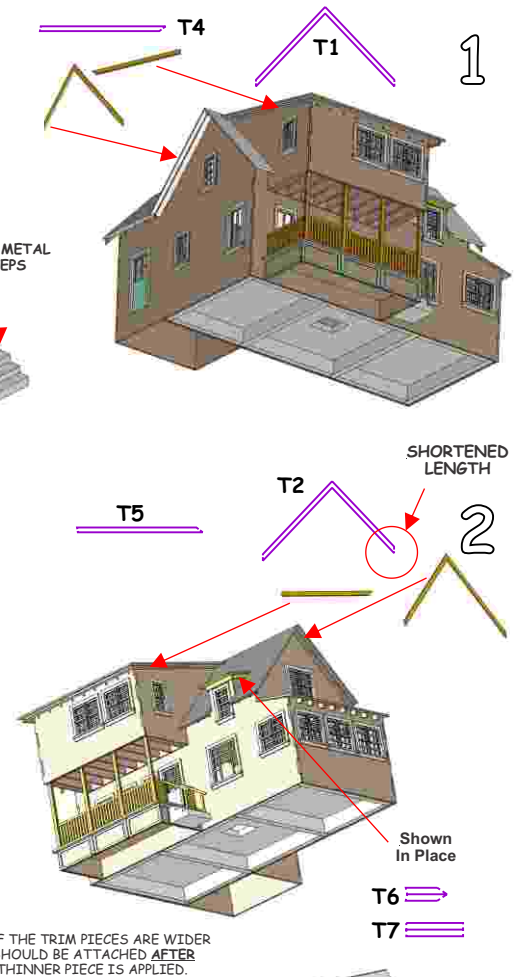

1

2

3

SOME OF THE TRIM PIECES ARE WIDER  
AND SHOULD BE ATTACHED AFTER  
THE THINNER PIECE IS APPLIED.

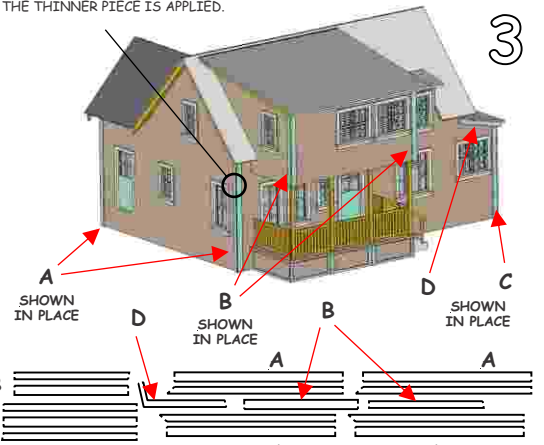

A SHOWN  
IN PLACE

B SHOWN  
IN PLACE

C SHOWN  
IN PLACE

B

A

A

C

A

A

ROOF TOP  
SIGN

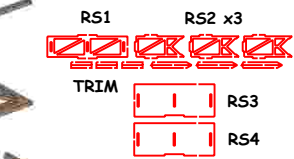

TRIM

TRIM

TRIM

TRIM

TRIM

TRIM

TRIM

STEP 5 - FRED'S ONE STOP

STEP 6 - FINAL DETAILS

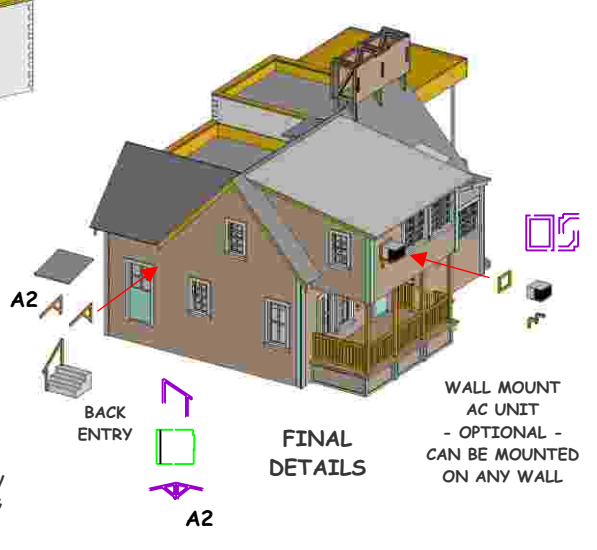
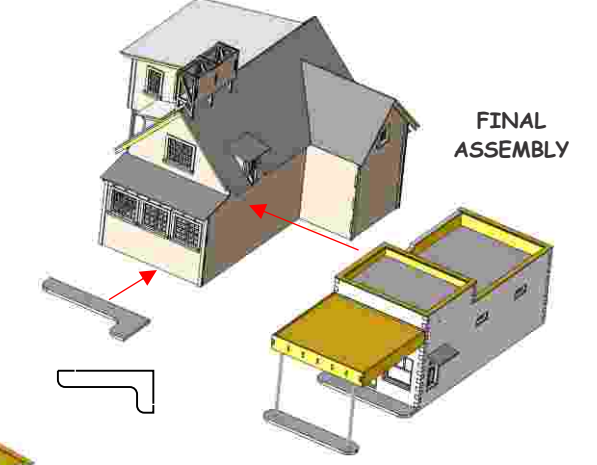
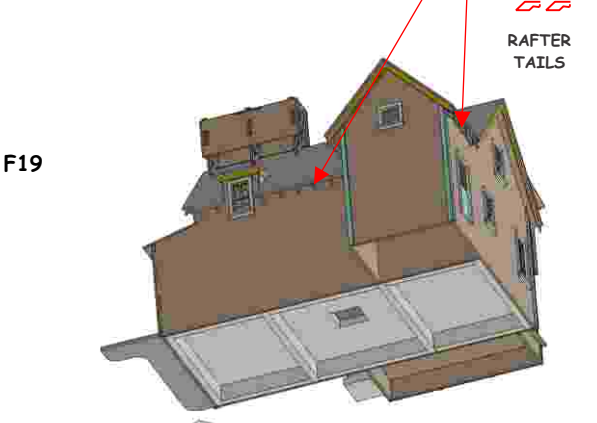
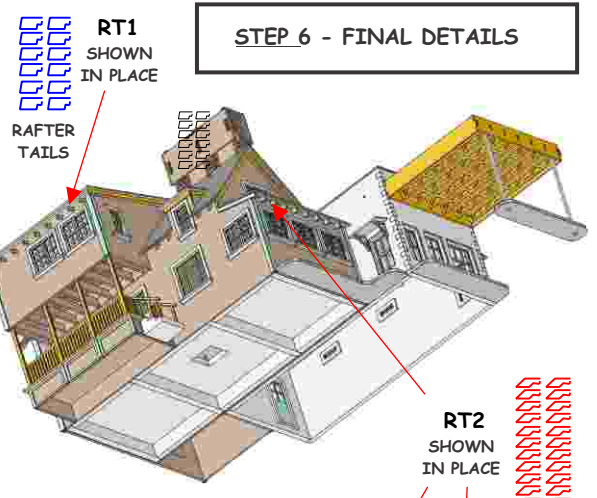
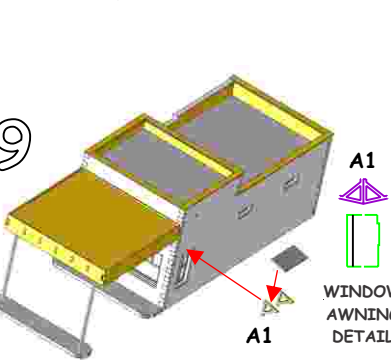
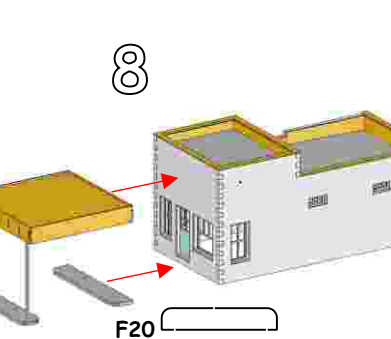
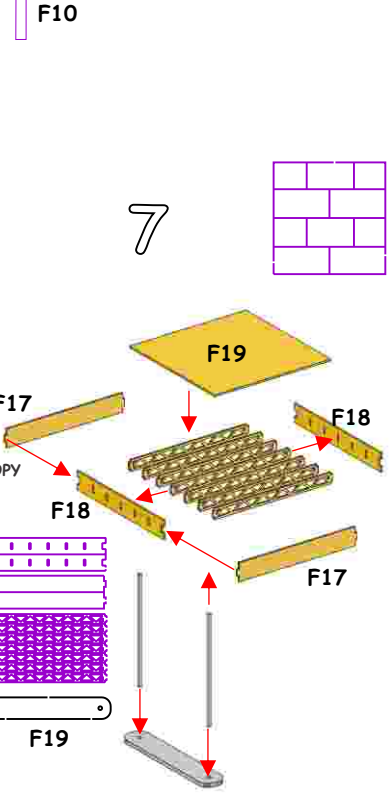
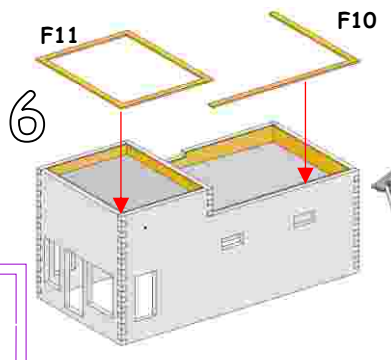
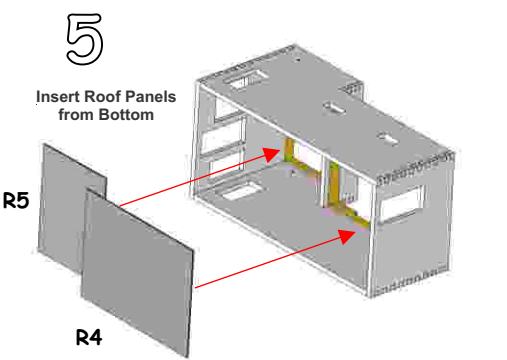
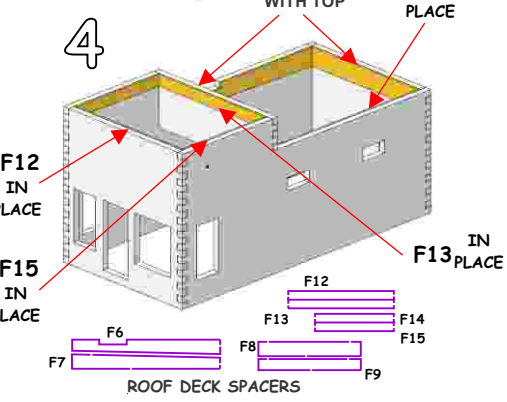
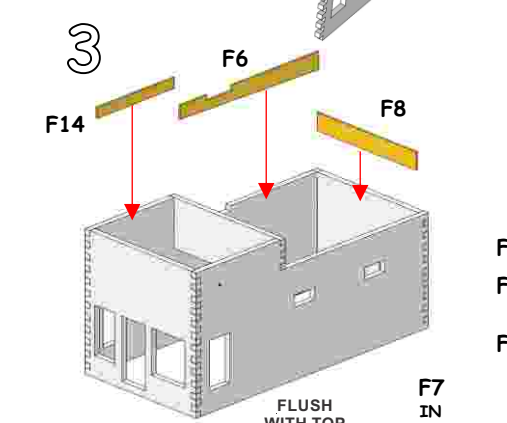
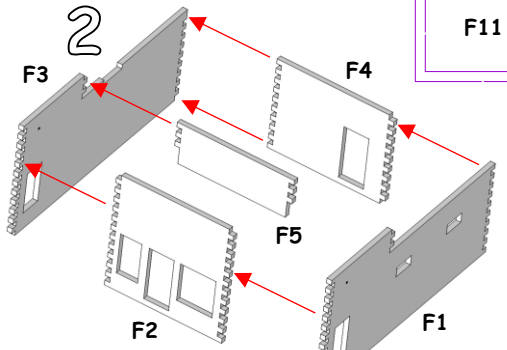
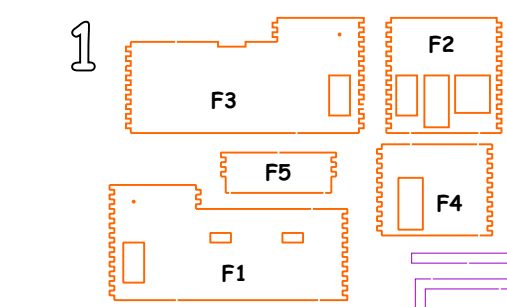

WALL MOUNT  
AC UNIT  
- OPTIONAL -  
CAN BE MOUNTED  
ON ANY WALL

### Wall Stiffener / Window Backing

The wall stiffener parts will aid in installing the window and door assemblies. Install these either before the walls are assembled - or - after they are assembled but before sub roof has been installed.

The window and door openings in the backing parts are slightly smaller than the corresponding holes in the wall board. Install these stiffeners / backing parts by centering the openings on each other.

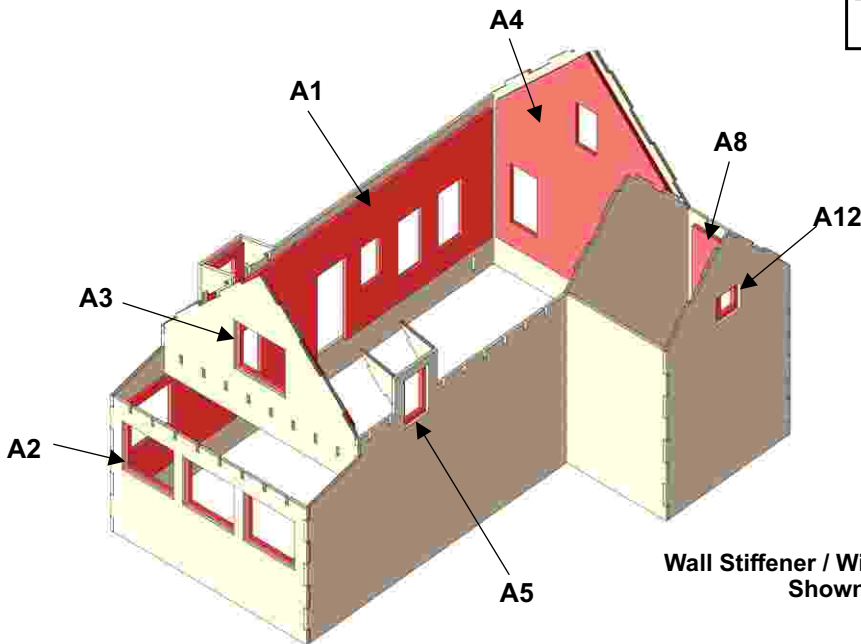
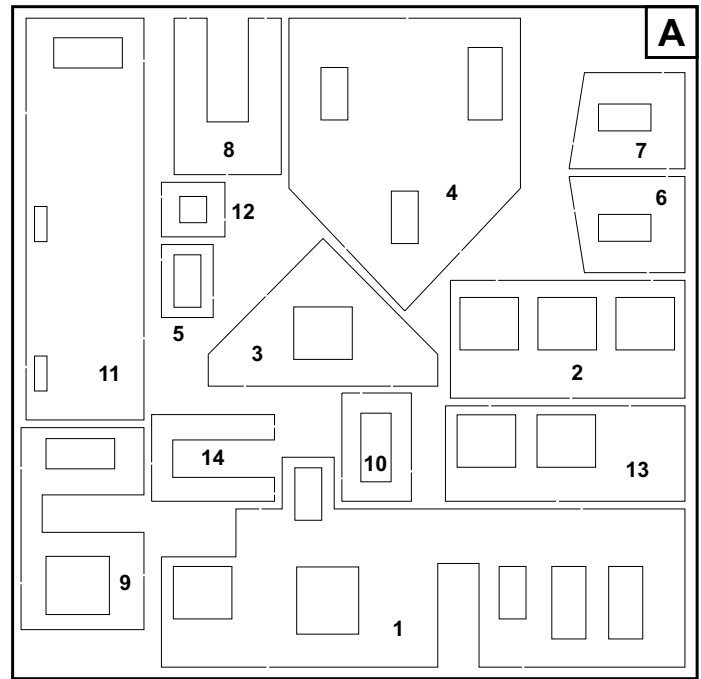

Wall Stiffener / Window Backing Parts Shown in Place.

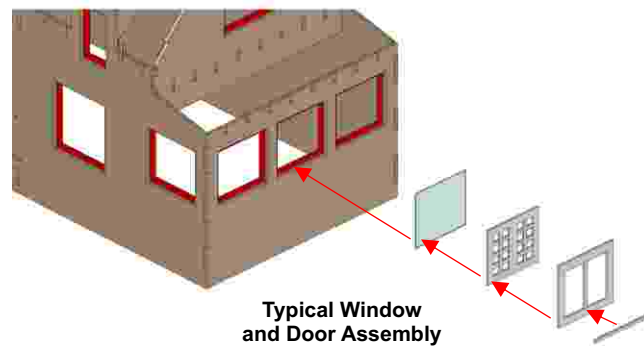
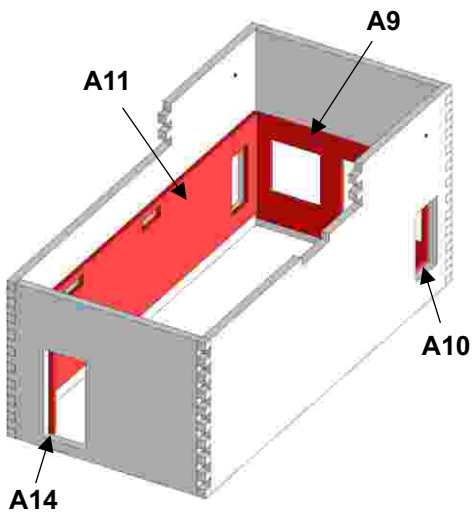
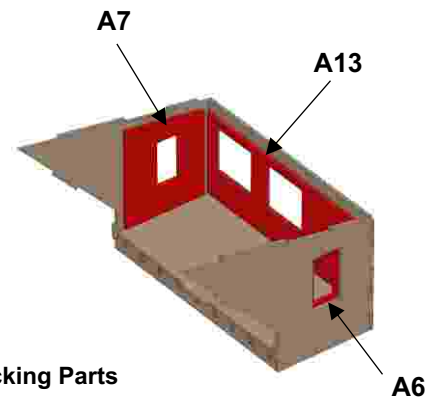

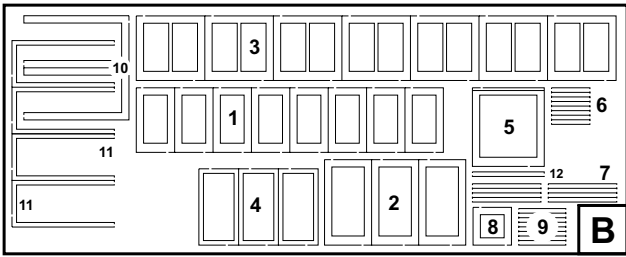

WINDOW AND DOOR PLACEMENT

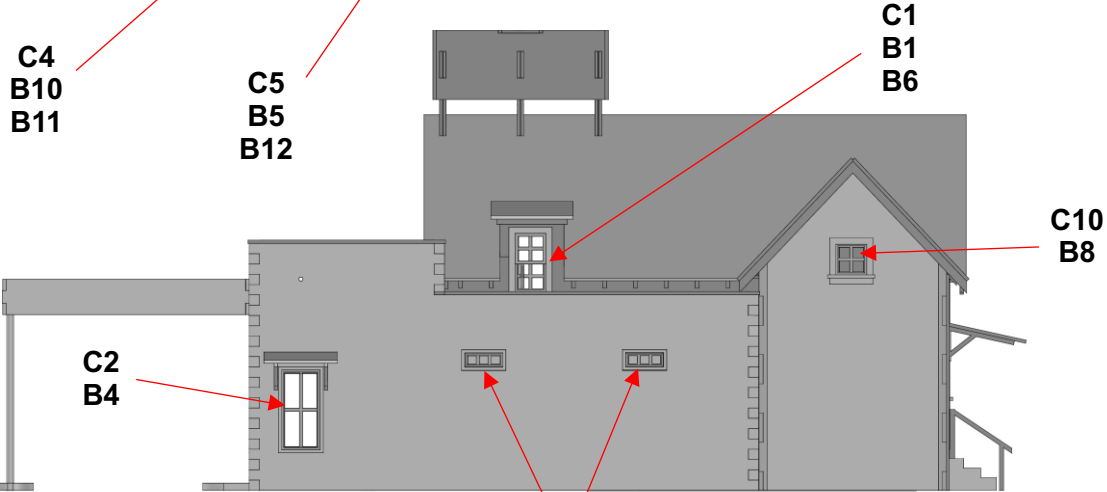
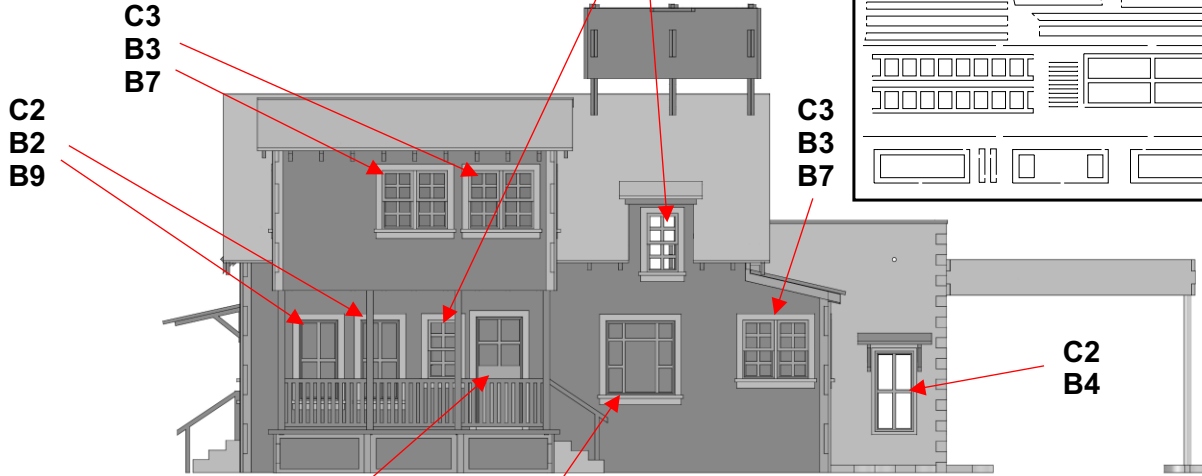
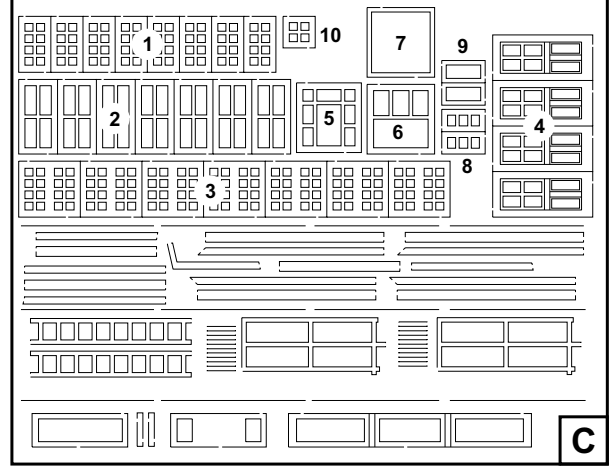

Glazing Sheet  
Not Shown

